

# Bill of Materials Listing

TransArctic Canada Inc.

4/28/2015  
Page 1 of 1

Product Number		Description	Bin	Date	Weight	Uof M	Yield
Line	Component Prod#	Description		Unit	Qty		
<b>KMC62494</b>		<b>Mt Kit, ISB 6.7, 2013, HDX, O5K, 12V,'13</b>		<b>08/26/13</b>	<b>141.64</b>		<b>0</b>
10	BEL22464	Belt, B gr, 2464mm (97") (BX94)		each	2		
20	BMC83123	Bkt, Main, Idler, ISL, HDX, '13		each	1		
30	BMC83125	Bkt, Weldm't, Adapter PI, ISL, HDX, '13		each	1		
40	BMC83129	Bkt, Weldm't, Main Base, ISL, HDX, '13		each	1		
60	KCB92494	Kit, Compressor, 12V,O5K, ISL, '13		each	1		
70	PUL80074	Pulley, Idler, B/S, Wide, 76d (89102)		each	2		
80	KPC64094	Kit, Pulley, 2B, ISB, 2013		each	1		
90	SCD21912	Spacer, Col, Drl,21.9mm x 25.4o x 12.3i		each	2		
100	SLV17012	Sleeve, Pulley, 16.9o x 22.23mm x 12.32i		each	2		
110	KBC84094	Bag Kit,Fasteners,KMC840/39/4194-9/62494		each	1		

# Bill of Materials Listing

TransArctic Canada Inc.

1/10/2017  
Page 1 of 1

Product Number		Description	Bin	Date	Weight	Uof M	Yield
Line	Component Prod#	Description		Unit	Qty		
<b>KBC84094</b>		<b>Bag Kit, Fasteners, KMC840/39/4194-9/62494</b>		<b>9/11/2013</b>	<b>2.16</b>		<b>0</b>
10	BTC10035	Bolt, Hex, 10 x 1.5 x 35mm, 10.9, Plt, FT		each	3		
30	BTC12080	Bolt, Hex, 12 x 1.75 x 80mm, 10.9, Plt, FT		each	2		
40	BTQ06125	Bolt, Hex, 3/8-16unc, 1.25", 8, Plt		each	5		
50	BTQ08125	Bolt, Hex, 1/2-13unc, 1.25", 8, Plt		each	2		
60	BTQ08151	Bolt, Hex, 1/2-20unf, 1.5", 8, Plt		each	2		
70	CSF08101	Capscrew, FH, 1/2-20unf x 1.0", Alloy, Plt		each	4		
80	NTA10000	Nut, Hex, 10 x 1.5, 8.8, Plt		each	3		
90	NTA12000	Nut, Hex, 12 x 1.75, 8.8, Plt		each	2		
100	NTQ06000	Nut, Hex, 3/8-16unc, 8, Plt		each	5		
110	WFA10002	Washer, Flat, 10mm, Hvy, 8.8, Plt		each	6		
120	WFA12000	Washer, Flat, 12mm, 8.8, Plt		each	1		
125	WFA12002	Washer, Flat, 12mm, Hvy, 8.8, Plt		each	1		
130	WFS06002	Washer, Flat, 3/8", L9, Plt		each	10		
140	WFQ08000	Washer, Flat, 1/2", 8, Plt		each	4		
150	WLA10000	Washer, Lock, 10mm, 8.8, Plt		each	3		
160	WLA12000	Washer, Lock, 12mm, 8.8, Plt		each	2		
170	WLQ06000	Washer, Lock, 3/8", 8, Plt		each	5		
180	WLQ08000	Washer, Lock, 1/2", 8, Plt		each	4		

# Bill of Materials Listing

TransArctic Canada Inc.

1/10/2017  
Page 1 of 1

Product Number	Description	Date	Weight	Uof M	Yield
Line    Component    Prod#	Description	Bin                    Unit	Qty		
<b>KCB92494</b>	<b>Kit, Compressor, 12V,O5K, ISL, '13</b>		<b>8/27/2013</b>	<b>53.44</b>	<b>0</b>
10	BMN80008		Vibration Isolator, Bar,16.50 x 2 x 1.50	each	2
20	BMN80025		Bkt, Back, PL, Slide, IC, RE300	each	1
30	BMZ00043		Bkt, Main, Base Pl, '13	each	1
40	KKT82461		Kit, Platform, O5K, '07	each	1
50	KBZ84194		Bag Kit, Fasteners, KCB84194/92494	each	1

# Bill of Materials Listing

TransArctic Canada Inc.

1/10/2017  
Page 1 of 1

Product Number	Description	Date	Weight	Uof M	Yield
Line    Component    Prod#	Description	Bin                    Unit	Qty		
<b>KBZ84194</b>	<b>Bag Kit, Fasteners, KCB84194/92494</b>	<b>10/18/2013</b>	<b>1.06</b>		<b>0</b>
10 BTP08653	Bolt, Hex, 1/2-13unc, 6.5", 5, Plt, FT	each	1		
20 BTQ08101	Bolt, Hex, 1/2-20unf, 1.00", 8, Plt	each	4		
30 CSF08076	Capscrew, FH, 1/2-20unf x .75",Alloy,Plt	each	2		
40 WFQ08000	Washer, Flat, 1/2", 8, Plt	each	4		
50 WLQ08000	Washer, Lock, 1/2", 8, Plt	each	5		

# Bill of Materials Listing

TransArctic Canada Inc.

4/28/2015  
Page 1 of 1

Product Number	Description	Date	Weight	Uof M	Yield
Line    Component    Prod#    Description	Bin	Unit	Qty		
<b>KKT82461</b>	<b>Kit, Platform, O5K, '07</b>	<b>10/19/07</b>	<b>13.98</b>		<b>0</b>
10 BMN80031	Bkt, Main, Slide, Assy, 05K, IC, RE300	each	1		
20 BMN80032	Bkt, Adapter, PL, IC, RE300	each	1		
30 CSF08100	Capscrew, FH, 1/2-13 x 1", Alloy, Plt	each	4		
40 NTP07000	Nut, Hex, 7/16-14unc, 5, Plt	each	4		
50 WFN07000	Washer, Flat, 7/16", 2, Plt	each	4		
60 WLP07000	Washer, Lock, 7/16", 5, Plt	each	4		

# Bill of Materials Listing

TransArctic Canada Inc.

4/28/2015  
Page 1 of 1

Product Number	Description	Date	Weight	Uof M	Yield
Line    Component    Prod#	Description	Bin            Unit	Qty		
<b>KPC64094</b>	<b>Kit, Pulley, 2B, ISB, 2013</b>		<b>05/13/08</b>	<b>14.32</b>	<b>0</b>
10	PUL67222		Pulley, Crank, ADD-ON, ISB,6.7L,2B/X,'07	each	1
20	CSS12090		Capscrew, SH, 12 x 1.25 x 90mm, 12.9,BLK	each	6
30	WFS12002		Washer, Flat, Hdn, 12mm, Stl, BLK	each	6

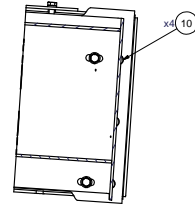
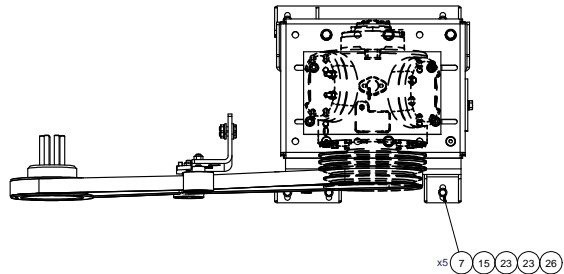

SECTION B-B

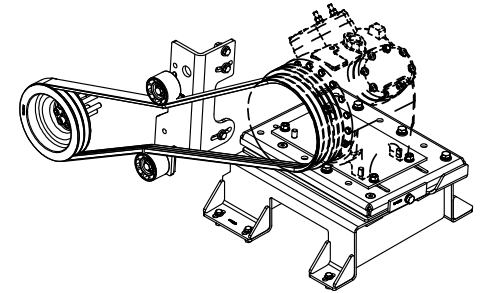

ISOMETRIC VIEW

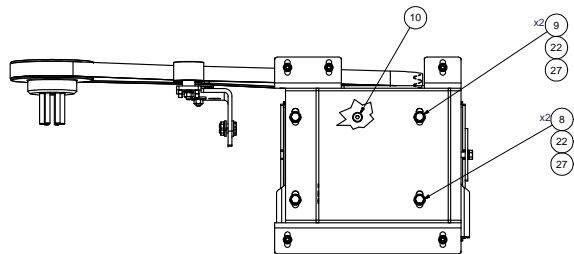
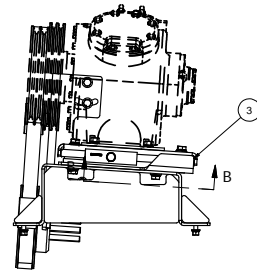
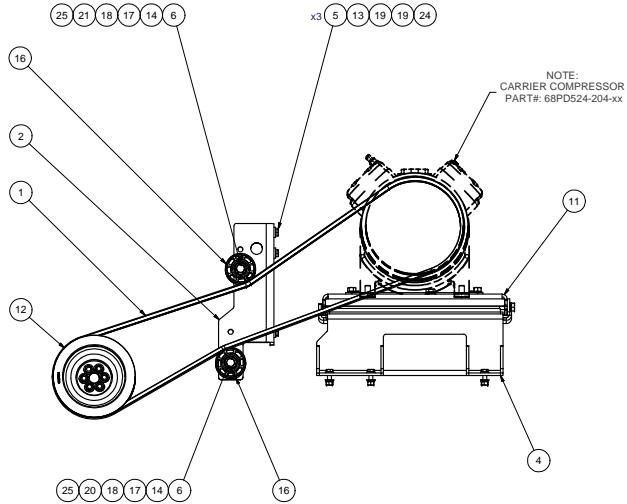

NOTES:  
 1) USE SERVICABLE THREADLOCKER ON ALL FASTENERS TO ENGINE COMPONENTS AND TORQUE ALL BOLTS TO S.A.E. SPECIFICATIONS.  
 2) SEE 'TRANSARCIG A/C COMPRESSOR MOUNT INSTALLATION DISCLAIMER'.

ITEM	QTY	U/M	PART NUMBER	DESCRIPTION
27	4	EACH	WLO08000	WASHER, LOCK, 1/2", 8, PLT
26	5	EACH	WLO06000	WASHER, LOCK, 3/8", 8, PLT
25	2	EACH	WLA12000	WASHER, LOCK, 12mm, 8.8, PLT
24	3	EACH	WLA10000	WASHER, LOCK, 10mm, 8.8, PLT
23	10	EACH	WFS06002	WASHER, FLAT, 3/8", L9, PLT
22	4	EACH	WFO08000	WASHER, FLAT, 1/2", 8, PLT
21	1	EACH	WFA12002	WASHER, FLAT, 12mm, HVY, 8.8, PLT
20	1	EACH	WFA12000	WASHER, FLAT, 12mm, 8.8, PLT
19	6	EACH	WFA10002	WASHER, FLAT, 10mm, HVY, 8.8, PLT
18	2	EACH	SLV17012	SLEEVE, PULLEY, 16.90 x 22.23 mm x12.19i
17	2	EACH	SCD21912	SPACER, COL, DRL, 21.9mm x 31.80 x12.3i
16	2	EACH	PUL80074	PULLEY, IDLER, BACKSIDE, P8, 74D, 46.27W
15	5	EACH	NTQ06000	NUT, HEX, 3/8-16UNC, 8, PLT
14	2	EACH	NTA12000	NUT, HEX, 12 x 1.75, 8.8, PLT
13	3	EACH	NTA10000	NUT, HEX, 10 x 1.5, 8.8, PLT
12	1	EACH	KPC64094	KIT, PULLEY, 2B, 15B, 2013
11	1	EACH	KCB92494	KIT, COMPRESSOR, 12V, O5K, ISL, '13
10	4	EACH	CSF08101	CAPSCREW, FH, 1/2-20UNF x 1", ALLOY, PLT
9	2	EACH	BTQ08151	BOLT, HEX, 1/2-20UNF x 1.50, 8, PLT
8	2	EACH	BTQ08125	BOLT, HEX, 1/2-13UNC x 1.25, 8, PLT
7	5	EACH	BTQ06125	BOLT, HEX, 3/8-16UNC x 1.25, 8, PLT
6	2	EACH	BTC12080	BOLT, HEX, 12 x 1.75 x 80mm, 10.9, PLT
5	3	EACH	BTC10035	BOLT, HEX, 10 x 1.5 x 35mm, 10.9, PLT
4	1	EACH	BMC83129	BKT, WELDMT, MAIN BASE, ISL, HDX, '13
3	1	EACH	BMC83125	BKT, WELDMT, ADAPTER PL, ISL, HDX, '13
2	1	EACH	BMC83123	BKT, MAIN, IDLER, WELDMT, ISL, HDX, '13
1	1	EACH	BEL22464	BELT, B gr, 2465mm (97')(BX94)

**TRANSARCIG INC.**

DRAWN	JRodriguez	4/27/2016
CHECKED	James Stewart	1/12/2015
REV	DATE	BY
1	1/12/2015	JR
2	1/12/2015	GA
3	1/12/2015	MS
4	1/12/2015	DM

DESCRIPTION:	RELEASED TO PRODUCTION	1/12/2015	JR
TITLE	MT KIT, ISL-D 2013, HDX, O5K, 12V, '13		
DATE	1/12/2015	BY	DM
SCALE	1:1	DWG NO	KMC62494
DRAWING UNIT OF MEASURE	MM (INCH)	REV	0
SHEET	1	OF	1

UNSPECIFIED TOLERANCES: H4.1 (M4)  
 ONE DECIMAL PLACE (X1) 0.1 (10%)  
 TWO DECIMAL PLACE (X2) 0.05 (5%)  
 THREE DECIMAL PLACE (X3) 0.025 (2.5%)  
 FRACTIONAL (1/16") ANGULAR ± .25°



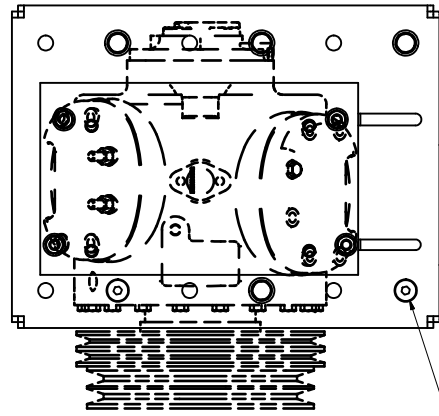

x2 6

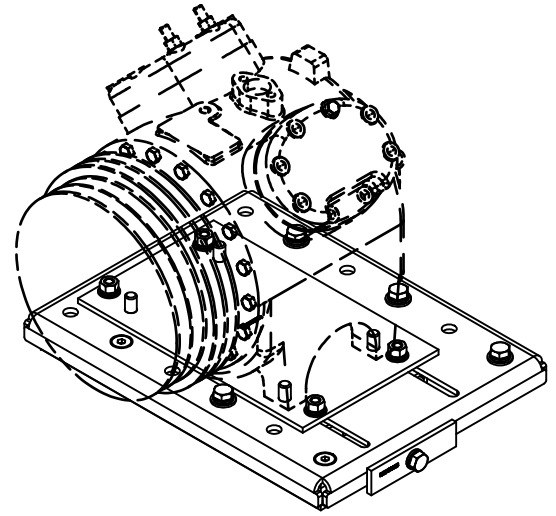

ISOMETRIC VIEW

NOTE:  
CARRIER COMPRESSOR  
PART#: 68PD524-204-xx

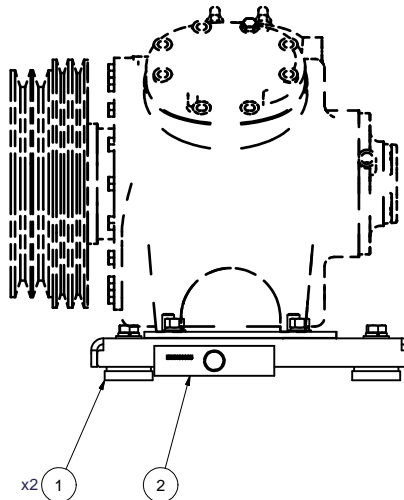
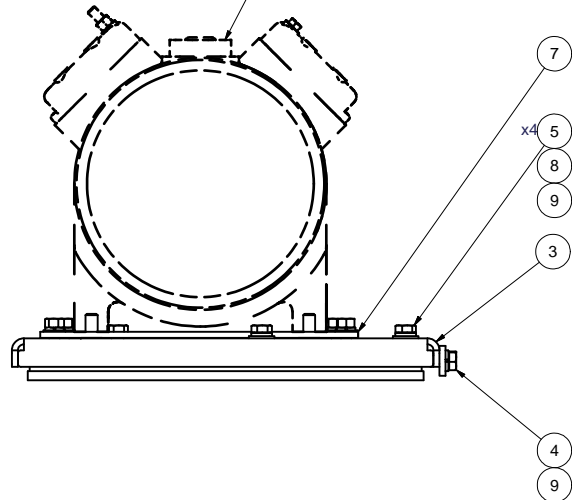

NOTES:

- 1) USE SERVICABLE THREADLOCKER ON ALL FASTENERS TO ENGINE COMPONENTS AND TORQUE **ALL** BOLTS TO S.A.E. SPECIFICATIONS.
- 2) SEE "TRANSARCTIC A/C COMPRESSOR MOUNT INSTALLATION DISCLAIMER".
- 3) WEIGHT: 49.71 LBS.

ITEM	QTY	U/M	PART NUMBER	DESCRIPTION
9	5	EACH	WLQ08000	WASHER, LOCK, 1/2", 8, PLT
8	4	EACH	WFO08000	WASHER, FLAT, 1/2", 8, PLT
7	1	EACH	KKT82461	MT KIT, TRANSIT, O5K, '07
6	2	EACH	CSF08076	CAPSCREW, FH, 1/2-20UNF x.75" ALLOY, PLT
5	4	EACH	BTQ08101	BOLT, HEX, 1/2-20UNF x 1.00, 8, PLT
4	1	EACH	BTP08653	BOLT, HEX, 1/2-13UNC x 6.50, 5, PLT, FT
3	1	EACH	BMZ00043	BKT, MAIN, BASE PL, '13
2	1	EACH	BMN80025	BKT, BACK, PL, SLIDE, IC, RE300
1	2	EACH	BMN80008	VIBRATION ISOLATOR, BAR, 16.50 x 2 x 1.50

BILL OF MATERIALS

DRAWN	jrodriguez	1/8/2015	<b>TRANSARCTIC INC.</b>
CHECKED	Val Jakowlew	1/8/2015	
REV	0A	1/8/2015	
APPROVED	James Stewart	1/8/2015	
MFG			TITLE
Ron Ingram			KIT, COMPRESSOR, 12V, O5K, ISL, '13
Dale Mason			SIZE
			C
DWG NO			KCB92494
DRAWING UNIT OF MEASURE:			SCALE
MM [INCH]			1:4
SHEET			1 OF 1
REV			0

0	RELEASED TO PRODUCTION.	1/8/2015	JRR
REV	ECN:	DESCRIPTION:	DATE: BY:
THIS DRAWING CONTAINS PROPRIETARY CONFIDENTIAL INFORMATION OWNED BY TRANSARCTIC CANADA INC. THE DOCUMENT AND THE INFORMATION IN IT ARE NOT TO BE USED, DISCLOSED OR REPRODUCED WITHOUT EXPRESS WRITTEN PERMISSION OF THE COMPANY.			
UNSPECIFIED TOLERANCES: [ALT. DIM.]			
ONE DECIMAL PLACE (.X)	.50	[.020]	
TWO DECIMAL PLACE (.XX)	.25	[.010]	
THREE DECIMAL PLACE (.XXX)	.10	[.005]	
FRACTIONAL +/- .002"	ANGULAR +/- .50°		
		THIRD ANGLE PROJECTION	



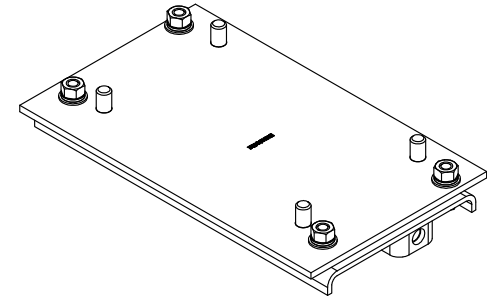
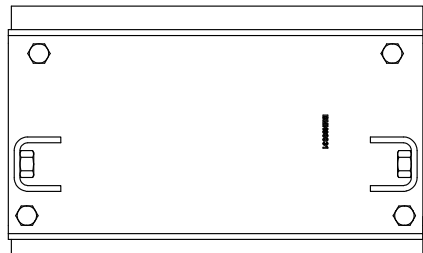
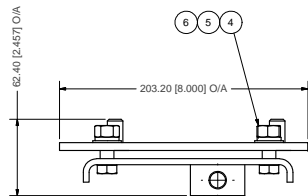
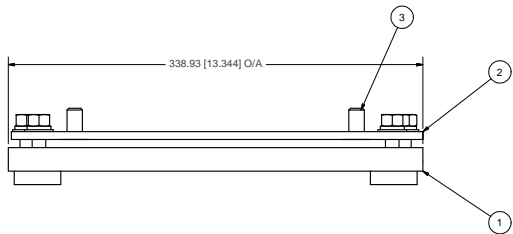
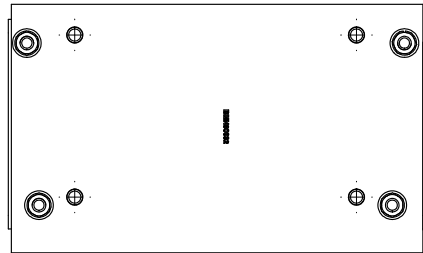

ISOMETRIC VIEW

**NOTES:**  
 1) USE SERVICABLE THREADLOCKER ON ALL FASTENERS TO ENGINE COMPONENTS AND TORQUE **ALL** BOLTS TO S.A.E. SPECIFICATIONS.  
 2) SEE 'TRANSARCTIC A/C COMPRESSOR MOUNT INSTALLATION DISCLAIMER'.  
 3) WEIGHT: 13.96 LBS.

ITEM	QTY	U/M	PART NUMBER	DESCRIPTION
5	4	EACH	WPN07000	WASHER, FLAT, 7/16", 2, PLT
6	4	EACH	WLP07000	WASHER, LOCK, 7/16", 5, PLT
4	4	EACH	NTP07000	NUT, HEX, 7/16-14UNC, 5, PLT
3	4	EACH	CSF08100	CAPSCREW, FH, 3/8-16 x 1", 9, PLT
2	1	EACH	BMN80032	BKT, ADAPTER, PL, IC, RE300
1	1	EACH	BMN80031	BKT, MAIN, SLIDE, ASSY, 05K, IC, RE300

TRANSARCTIC INC.

UNSPECIFIED TOLERANCES:	PLT DIM	PREC
ONE DECIMAL PLACE (.X)	30	1000
TWO DECIMAL PLACE (.XX)	30	1000
THREE DECIMAL PLACE (.XXX)	30	1000
FRACTIONAL (1/16")	ANGULAR	± .01

DRAWN	vjakowlew	10/20/2008	TITLE
CHECKED	vjakowlew	10/20/2008	
REVISION	DESCRIPTION	DATE	BY
1	RELEASED TO PRODUCTION	10/20/2008	JRS
2			GA
3			James Stewart
4			MFG
5			Ron Ingram
6			APPROVED
7			Dale Mason

MT KIT, TRANSIT, 05K, '07

SIZE	D	DWG NO	KKT82461	REV	0
DRAWING UNIT OF MEASURE	MM (INCH)	SCALE	1:2	SHEET	1 OF 1

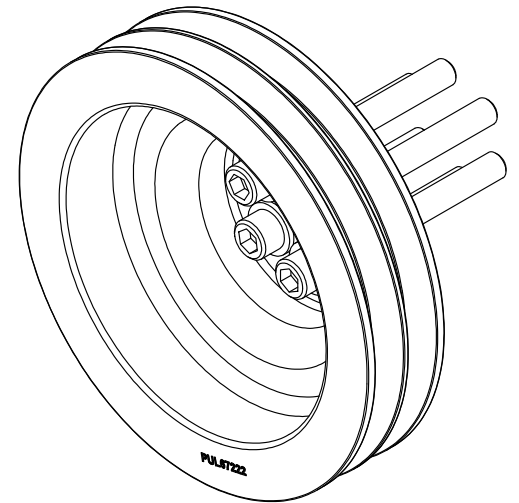
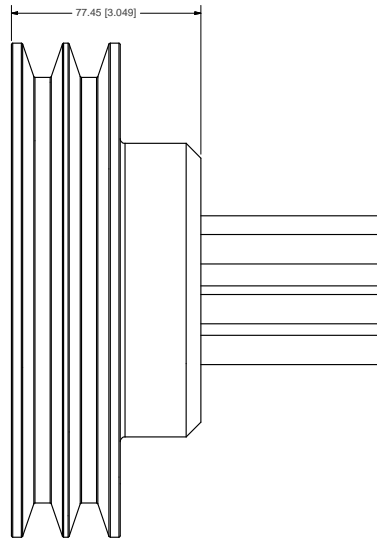
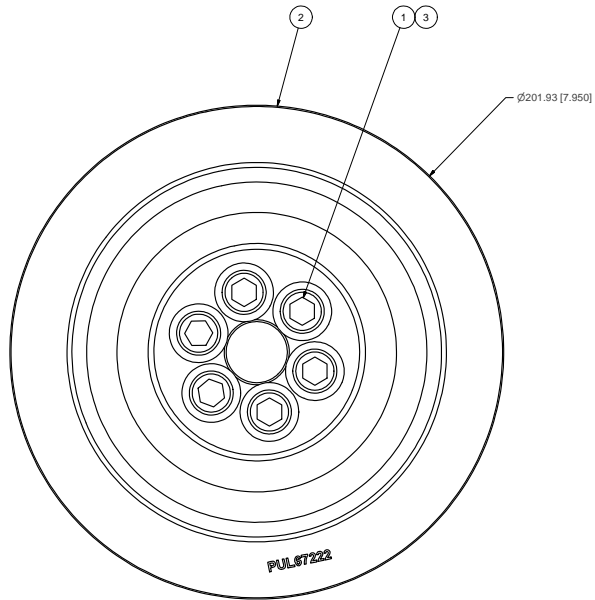
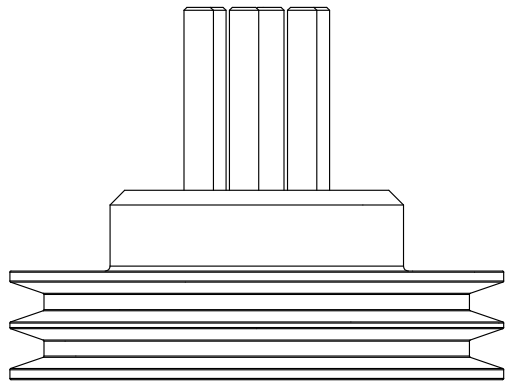

ISOMETRIC VIEW

NOTES:

- 1) USE SERVICABLE THREADLOCKER ON ALL FASTENERS TO ENGINE COMPONENTS AND TORQUE **ALL BOLTS** TO S.A.E. SPECIFICATIONS.
- 2) SEE "TRANSARTIC A/C COMPRESSOR MOUNT INSTALLATION DISCLAIMER".
- 3) WEIGHT: 13.24 LB

ITEM	QTY	U/M	PART NUMBER	DESCRIPTION
3	6	EACH	WFS12002	WASHER, FLAT, HDN, 12mm, STL, BLK
2	1	EACH	PUL67222	PULLEY, CRANK, ADD-ON, ISB, 5.7L, 2B/IX '07
1	6	EACH	CSS12090	CAPSCREW, SH, 12 x 1.25 x 90mm, 12.9, FLT

**TRANSARTIG INC.**

U	RELEASED TO PRODUCTION	11/6/2013	JRR
REV	DESCRIPTION	DATE	BY
1		11/6/2013	James Stewart
2		10/21/2008	MFG
3		11/6/2013	Ron Ingram
4		11/6/2013	Dale Mason

THIS DRAWING CONTAINS PROPRIETARY CONFIDENTIAL INFORMATION OWNED BY TRANSARTIC CANADA INC. THE DOCUMENT AND THE INFORMATION IN IT ARE NOT TO BE USED, DISCLOSED OR REPRODUCED WITHOUT EXPRESS WRITTEN PERMISSION OF THE COMPANY.

UNSPECIFIED TOLERANCES:			
ONE DECIMAL PLACE (X.1)	MM	±.050	(.002)
TWO DECIMAL PLACE (X.01)	MM	±.010	(.0005)
THREE DECIMAL PLACE (X.001)	MM	±.005	(.0002)
FRACTIONAL (1/16")	ANGULAR	±.25	(.005)



DRAWN	Jose Rodriguez	11/6/2013	
CHECKED	Val Jakowlew	11/6/2013	
APPROVED	Ron Ingram	11/6/2013	
DATE	Dale Mason	11/6/2013	
DRAWING UNIT OF MEASURE	MM (INCH)		

TITLE  
KIT, PULLEY, 2B, ISB, 2013

SIZE  
D

DWG NO  
KPC64094

REV  
0

SCALE  
1:1

SHEET  
1 OF 1

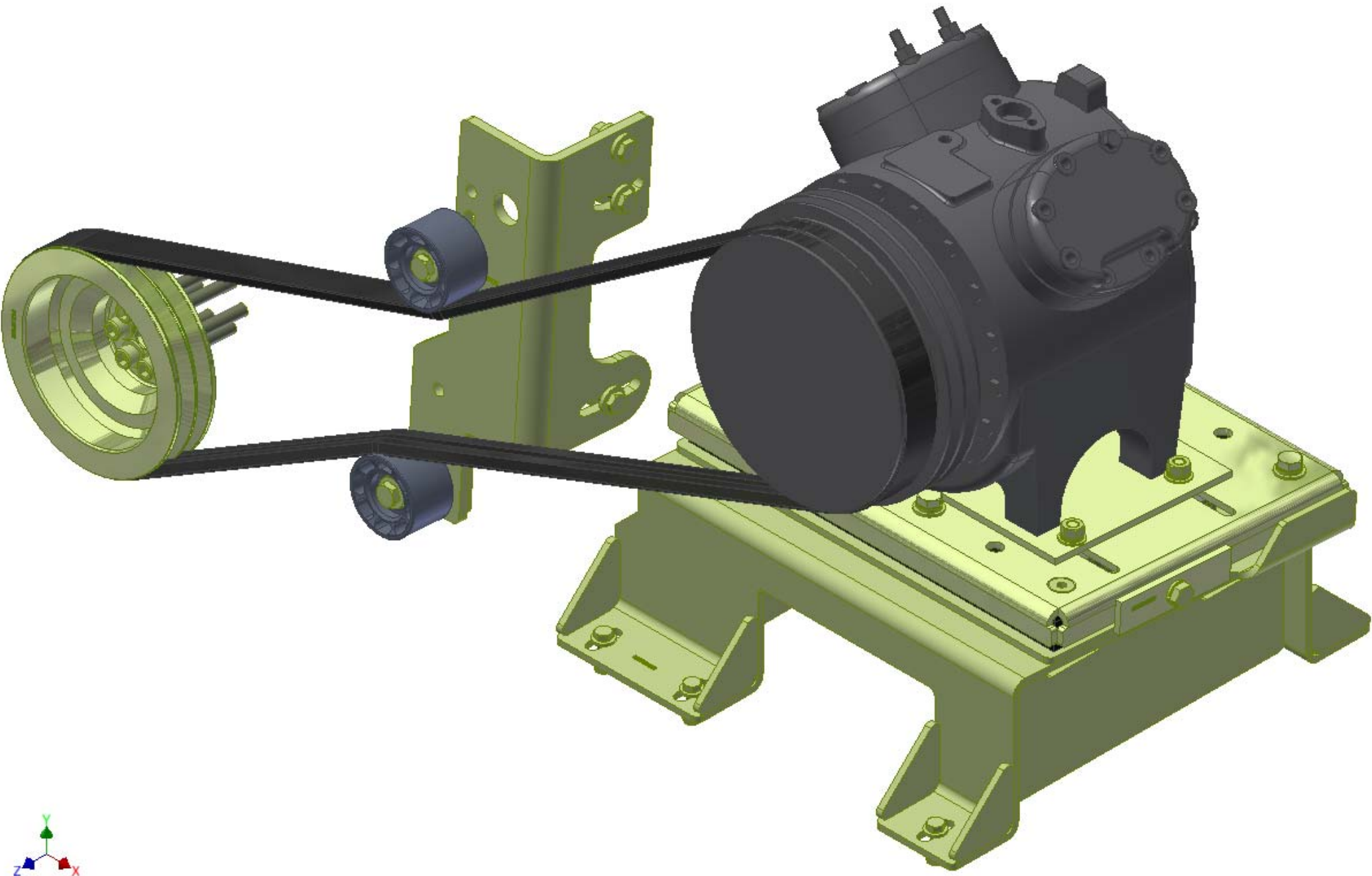

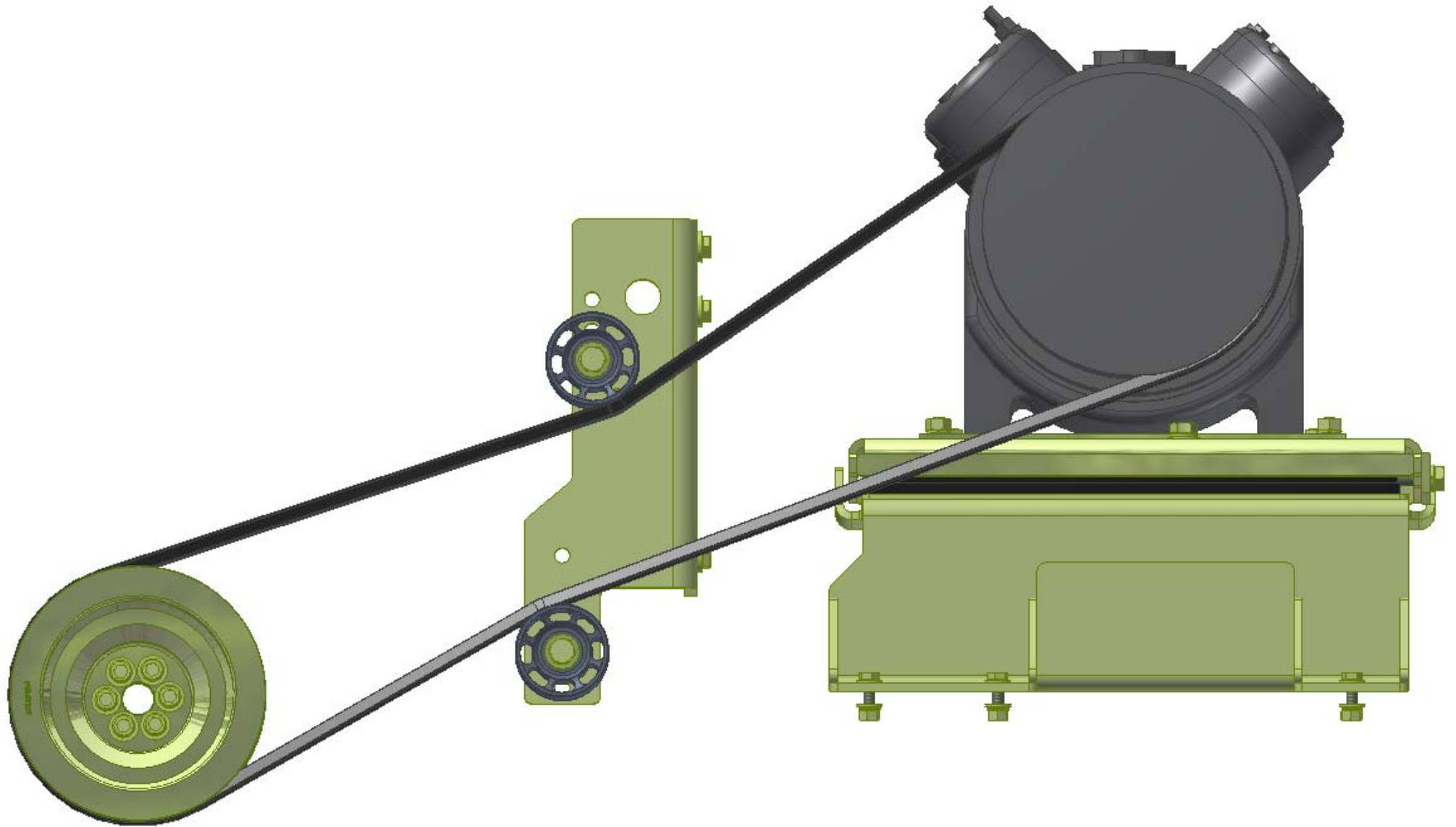



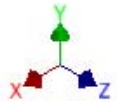
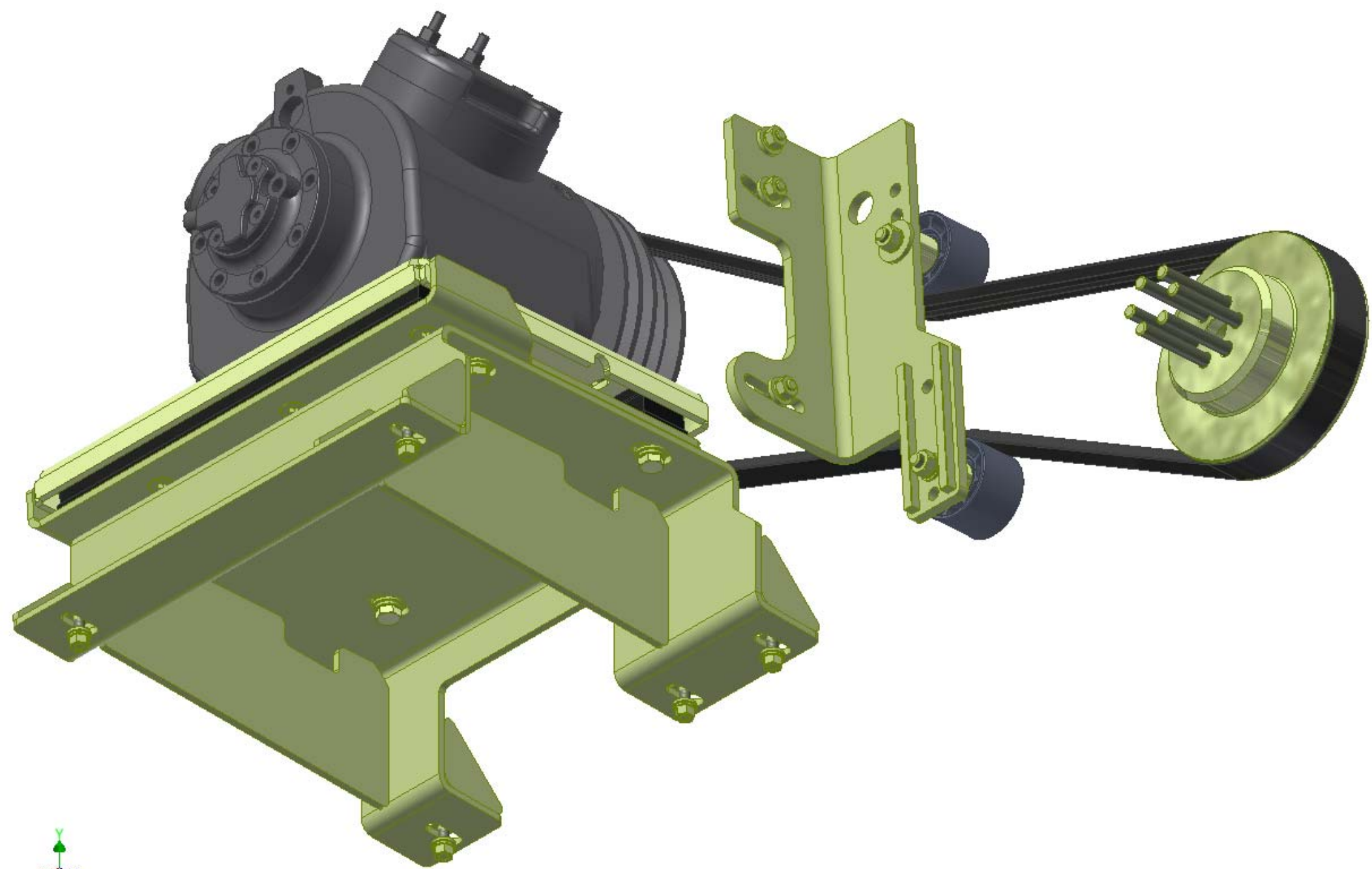



## **TransArctic A/C Compressor Mount Installation Disclaimer**

All compressor mounts should be installed by qualified and trained personnel using proper tools and equipment in safe working conditions following industry standard guidelines for motor vehicle service and repair.

The installer of any compressor mount purchased from TransArctic must undertake all responsibility of issues arising from that compressor bracket being installed on any vehicle. As well as insure that a **proper and sufficient ground** is established between the compressors' clutches and the vehicle's engine. Mount functionality, operation and durability can all be compromised by an incompetent installation.

Due to the many different situations, parameters and application criteria, which are beyond the compressor mount manufacturer's control, TransArctic does not warrant design, durability, or operational functionality of any compressor mount improperly installed by another party.

**With no implied guarantees it is the mount installer's strict responsibility to determine safety and functionality, of the compressor mount, at the time of installation.**

Please contact TransArctic with any issue arising from installation so we may better improve the product. If you have any reservations about the compressor mount integrity contact TransArctic immediately at 1-877-COLD-AIR.

**Mark OEM tensioner location**

**Install Kit**

**Check for Interferences**

**Check to ensure that the proper OEM tensioner orientation is maintained**

**Run engine with A/C system engaged for at least 10 minutes to run in belt**

**Check OEM tensioner orientation and adjust as required**

### **Responsabilidad limitada de TransArctic en la instalación del soporte del compresor**

Todos los soportes de los compresores deben ser instalados por personas calificadas y entrenadas, usando para ello los equipos y herramientas necesarios para esta labor en buenas condiciones y según las normas y guías para el servicio y/o reparación de motores de vehículos.

El instalador de los soportes comprados en TransArctic asume toda la responsabilidad de cualquier problema que surga en el soporte del compresor al vehículo; de igual manera es responsable que el cable a tierra sea conectado entre el embrague del compresor y el motor del vehículo.

Se advierte que el buen funcionamiento y la durabilidad del soporte pueden ser comprometidos por defectos en su instalación.

Debido a las diversas situaciones que se puedan presentar fuera del control del fabricante, TransArctic no garantiza el diseño, la durabilidad o el correcto funcionamiento de cualquier equipo inapropiadamente instalado por terceros.

**Esta sobreentendido que el Instalador del montaje del compresor es estrictamente responsable de la seguridad y funcionamiento del equipo en el momento de la instalación.**

Si tuviera algún problema o duda acerca de la instalación del soporte del compresor pongase en contacto inmediatamente con TransArctic al teléfono 1-877-COLD-AIR de modo que podamos mejorar nuestro producto.

**Note la ubicación del medidor de tensión OEM**

**Instale el equipo**

**Controlar si hay interferencias.**

**Asegurese que el medidor de tensión mantenga la orientación justa.**

**Encienda el motor por lo menos 10 minutos con el sistema A/C enganchado para que la correa corra**

**Controle la orientación justa del medidor de tensión y ajuste a las condiciones requeridas del fabricante**