

Bill of Materials Listing

TransArctic Canada Inc.

11/11/2016
Page 1 of 1

Product Number	Description	Date	Weight	Uof M	Yield
Line Component Prod#	Description	Bin Unit	Qty		
KMC64194	Mt Kit, ISB 2013, HDX, 05G, 24V, '13		10/11/2013	170.90	0
10	BEL32616		Belt, Banded B, 2616mm (103") (RBX100-2)	each	1
20	BMC83123		Bkt, Main, Idler, Weldm't, ISL, HDX, '13	each	1
30	BMC83125		Bkt, Weldm't, Adapter Pl, ISL, HDX, '13	each	1
40	BMC83129		Bkt, Weldm't, Main Base, ISL, HDX, '13	each	1
45	KAN86530		Kit, Alt. 24V, MForce DT, RE300, 07-08	each	1
50	KCB84194		Kit, Compressor, 24V, O5G, ISL, '13	each	1
60	KPC64194		Kit, Pulley, 10"dia, 2B, ISB, 2013	each	1
70	PUA05012		Pulley, Assy, Idler, B/BX gr, 5", STL, Plt	each	1
75	PUL80074		Pulley, Idler, B/S, Wide, 76d (89102)	each	1
80	SCD46012		Spacer, Col, Drl, 46mm x 31.8o x 12.0i	each	1
85	SCD49512		Spacer, Col, Drl, 49.48mm x 25.4o x 12.3i	each	1
90	SLV17012		Sleeve, Pulley, 16.9o x 22.23mm x 12.32i	each	2
100	KBC64194		Bag Kit, Fasteners, KMC64194	each	1

Bill of Materials Listing

TransArctic Canada Inc.

1/10/2017
Page 1 of 1

Product Number		Description	Bin	Date	Weight	Uof M	Yield
Line	Component Prod#	Description		Unit	Qty		
KBC64194		Bag Kit, Fasteners, KMC64194		8/7/2014	2.27		0
10	BTC10035	Bolt, Hex, 10 x 1.5 x 35mm, 10.9, Plt,FT		each	3		
30	BTC12110	Bolt, Hex, 12 x 1.75 x 110mm, 10.9, Plt		each	2		
40	BTQ06125	Bolt, Hex, 3/8-16unc, 1.25", 8, Plt		each	5		
50	BTQ08125	Bolt, Hex, 1/2-13unc, 1.25", 8, Plt		each	2		
60	BTQ08151	Bolt, Hex, 1/2-20unf, 1.5", 8, Plt		each	2		
70	CSF08101	Capscrew, FH, 1/2-20unf x 1.0",Alloy,Plt		each	4		
80	NTA10000	Nut, Hex, 10 x 1.5, 8.8, Plt		each	3		
90	NTA12000	Nut, Hex, 12 x 1.75, 8.8, Plt		each	2		
100	NTQ06000	Nut, Hex, 3/8-16unc, 8, Plt		each	5		
110	WFA10002	Washer, Flat, 10mm, Hvy, 8.8, Plt		each	6		
120	WFA12000	Washer, Flat, 12mm, 8.8, Plt		each	1		
125	WFA12002	Washer, Flat, 12mm, Hvy, 8.8, Plt		each	1		
130	WFAQ08000	Washer, Flat, 1/2", 8, Plt		each	4		
140	WFS06002	Washer, Flat, 3/8", L9, Plt		each	10		
150	WLA10000	Washer, Lock, 10mm, 8.8, Plt		each	3		
160	WLA12000	Washer, Lock, 12mm, 8.8, Plt		each	2		
170	WLQ06000	Washer, Lock, 3/8", 8, Plt		each	5		
180	WLQ08000	Washer, Lock, 1/2", 8, Plt		each	4		

Bill of Materials Listing

TransArctic Canada Inc.

8/7/2014
Page 1 of 1

Product Number	Description	Date	Weight	Uof M	Yield
Line Component Prod#	Description	Bin Unit	Qty		
KAN86530	Kit, Alt. 24V, MForce DT, RE300, 07-08		10/4/2007	21.31	0
5	PAC12110		Pack, Carton, 12" x 11" x 5", 51 ECT	each	1
10	BEL11245		Belt, A gr, 1245mm (49.0") (17490)	each	2
20	BMN80051		Bkt, Alt, Weldm't, D/S, O5G/K	each	1
30	BMN80052		Bkt, Alt, Weldm't,P/S, O5G/K	each	1
35	PUL03321		Pulley, ALT, Idler, 3.25"d, 2A	each	1
40	SCD84713		Spacer, Col, Drl, 84.7mm x 25.4o x 13.3i	each	1
50	BMT10008		Bkt, Tenr, Block, Offset	each	1
60	BMT10009		Bkt, Tenr, Block, Tapped	each	1
70	KBN86530		Bag Kit, Fasteners, KAN86530	each	1

Bill of Materials Listing

TransArctic Canada Inc.

8/7/2014
Page 1 of 1

Product Number	Description	Date	Weight	Uof M	Yield
Line Component Prod#	Description	Bin Unit	Qty		
KBN86530	Bag Kit, Fasteners, KAN86530		10/4/2007	7.35	0
10	TRD08120		Threaded, Rod, 1/2-13unc x 12", 5, Plt	piece	1
20	BTQ08653		Bolt, Hex, 1/2-13unc, 6.5", 8, Plt	each	1
30	BTQ08150		Bolt, Hex, 1/2-13unc, 1.5", 8, Plt	each	1
40	BTS06438		Bolt, Stud, 3/8-16unc, 3.25" x .88", PLT	each	12
50	BTQ06200		Bolt, Hex, 3/8-16unc, 2.0", 8, Plt	each	1
60	NTP08000		Nut, Hex, 1/2-13unc, 5, Plt	each	4
70	NTP06000		Nut, Hex, 3/8-16unc, 5, Plt	each	13
80	WFQ08000		Washer, Flat, 1/2", 8, Plt	each	5
90	WFN06000		Washer, Flat, 3/8", 2, Plt	each	26
100	WLP08000		Washer, Lock, 1/2", 5, Plt	each	4
110	WLP06000		Washer, Lock, 3/8", 5, Plt	each	13

Bill of Materials Listing

TransArctic Canada Inc.

8/7/2014

Page 1 of 1

Product Number		Description	Bin	Date	Weight	Uof M	Yield
Line	Component	Prod#	Description	Unit	Qty		
KCB84194			Kit, Compressor, 24V,O5G, ISL, '13		8/27/2013	50.22	0
10	BMN80008		Vibration Isolator, Bar,16.50 x 2 x 1.50	each		2	
20	BMN80025		Bkt, Back, PL, Slide, IC, RE300	each		1	
30	BMZ00043		Bkt, Main, Base Pl, '13	each		1	
40	KGT84161		Kit, Platform, O5G, '07	each		1	
50	KBZ84194		Bag Kit, Fasteners, KCB84194	each		1	

Bill of Materials Listing

TransArctic Canada Inc.

8/7/2014
Page 1 of 1

Product Number	Description	Date	Weight	Uof M	Yield
Line Component Prod#	Description	Bin Unit	Qty		
KBZ84194	Bag Kit, Fasteners, KCB84194	10/18/2013	1.06		0
10 BTP08653	Bolt, Hex, 1/2-13unc, 6.5", 5, Plt, FT	each	1		
20 BTQ08101	Bolt, Hex, 1/2-20unf, 1.00", 8, Plt	each	4		
30 CSF08076	Capscrew, FH, 1/2-20unf x .75", Alloy, Plt	each	2		
40 WFQ08000	Washer, Flat, 1/2", 8, Plt	each	4		
50 WLQ08000	Washer, Lock, 1/2", 8, Plt	each	5		

Bill of Materials Listing

TransArctic Canada Inc.

11/11/2016

Page 1 of 1

Product Number		Description	Bin	Date	Weight	Uof M	Yield
Line	Component Prod#	Description		Unit	Qty		
KGT84161		Kit, Platform, O5G, '07		10/19/2007	10.76		0
10	BMN80010	Bkt, Main, Slide, Assy, O5G, IC, RE300		each	1		
20	BMN80024	Bkt, Comp, FRT, Z, IC, RE300		each	1		
30	SCD29213	Spacer, Col, Drl, 29.21mm x 25.4o x 12.7i		each	2		
40	BTQ06150	Bolt, Hex, 3/8-16unc, 1.50", 8, Plt		each	2		
50	NTP07000	Nut, Hex, 7/16-14unc, 5, Plt		each	4		
60	WFN06000	Washer, Flat, 3/8", 2, Plt		each	2		
70	WLP07000	Washer, Lock, 7/16", 5, Plt		each	4		
80	WLP06000	Washer, Lock, 3/8", 5, Plt		each	2		

Bill of Materials Listing

TransArctic Canada Inc.

8/7/2014
Page 1 of 1

Product Number		Description	Bin	Date	Weight	Uof M	Yield
Line	Component Prod#	Description		Unit	Qty		
KPC64194		Kit, Pulley, 10" dia, 2B, ISB, 2013		5/13/2008	18.93		0
10	PUL67223	Pulley, Crank, ADD-ON, 10"d,ISB,2B/X,'13		each	1		
20	CSS12090	Capscrew, SH, 12 x 1.25 x 90mm, 12.9,BLK		each	6		
30	WFS12002	Washer, Flat, Hdn, 12mm, Stl, BLK		each	6		

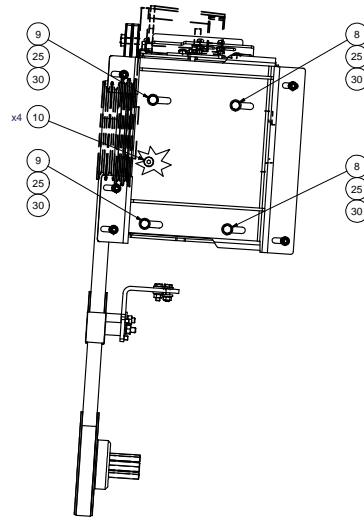
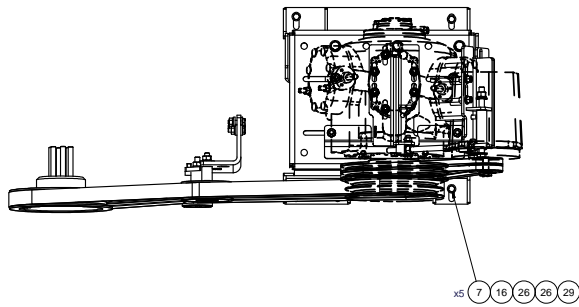

SECTION A-A

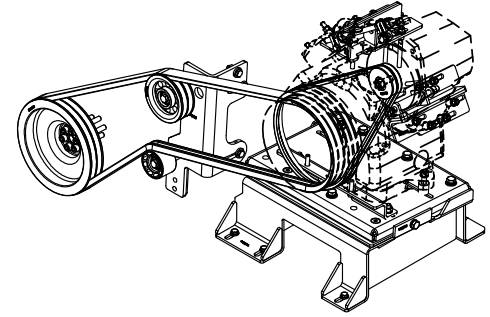

ISOMETRIC VIEW

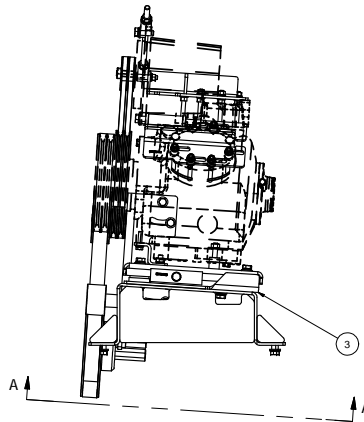
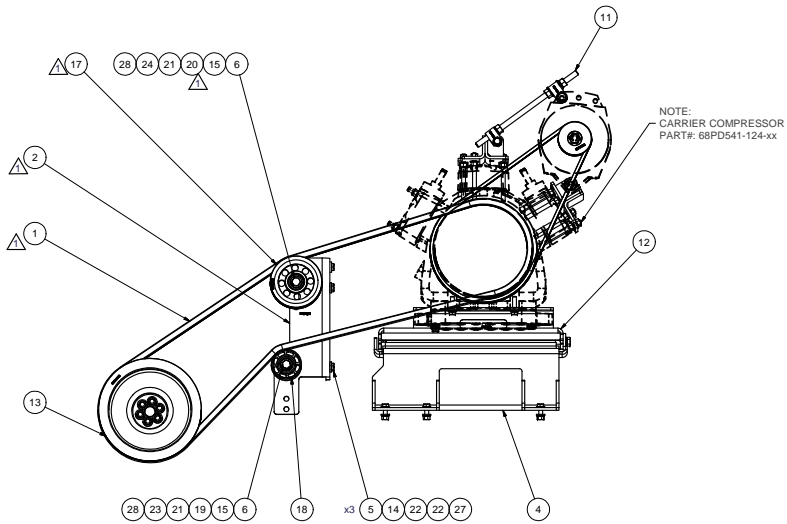

NOTES:

- 1) USE SERVICABLE THREADLOCKER ON ALL FASTENERS TO ENGINE COMPONENTS AND TORQUE ALL BOLTS TO S.A.E. SPECIFICATIONS.
- 2) SEE "TRANSARCTIC A/C COMPRESSOR MOUNT INSTALLATION DISCLAIMER".

ITEM	QTY	U/M	PART NUMBER	DESCRIPTION
30	4	EACH	WLO8000	WASHER, LOCK, 1/2", 8, PLT
29	5	EACH	WLO8600	WASHER, LOCK, 3/8", 8, PLT
28	2	EACH	WL12000	WASHER, LOCK, 12mm, 8.8, PLT
27	3	EACH	WL10000	WASHER, LOCK, 10mm, 8.8, PLT
26	10	EACH	WFS06002	WASHER, FLAT, 3/8", L9, PLT
25	4	EACH	WFO8000	WASHER, FLAT, 1/2", 8, PLT
24	1	EACH	WFA12002	WASHER, FLAT, 12mm, HVY, 8.8, PLT
23	1	EACH	WFA12000	WASHER, FLAT, 12mm, 8.8, PLT
22	6	EACH	WFA10002	WASHER, FLAT, 10mm, HVY, 8.8, PLT
21	2	EACH	SLV17012	SLEEVE, PULLEY, 16.90 x 22.23 mm x12.19l
20	1	EACH	SCD49512	SPACER, COL, DRL, 49.48mm x 25.40 x 12.3
19	1	EACH	SCD46012	SPACER, COL, DRL, 46mm x 31.80 x 12.0l
18	1	EACH	PLI80074	PULLEY, IDLER, BACKSIDE, P8, 74D, 46.27W
17	1	EACH	PUA05012	PULLEY, ASSY, IDLER, B/BX gr, 5" STL, PLT
16	5	EACH	NTQ06000	NUT, HEX, 3/8-16UNC, 8, PLT
15	2	EACH	NTA12000	NUT, HEX, 12 x 1.75, 8.8, PLT
14	3	EACH	NTA10000	NUT, HEX, 10 x 1.5, 8.8, PLT
13	1	EACH	KPC64194	KIT, PULLEY, 10" DIA, 2B, ISB, 2013
12	1	EACH	KCB84194	KIT, COMPRESSOR, 24V, 05G, ISL, '13
11	1	EACH	KAN86530	ALT, KIT, 24, H/FORCE D/T, RE300, 07"
10	4	EACH	CSF08101	CAPSCREW, FH, 1/2-20UNF x 1", ALLOY, PLT
9	2	EACH	BTQ08151	BOLT, HEX, 1/2-20UNF x 1.50, 8, PLT
8	2	EACH	BTQ08125	BOLT, HEX, 1/2-13UNC x 1.25, 8, PLT
7	5	EACH	BTQ06125	BOLT, HEX, 3/8-16UNC x 1.25, 8, PLT
6	2	EACH	BTC12110	BOLT, HEX, 12 x 1.75 x 110mm, 10.9, PLT
5	3	EACH	BTC10035	BOLT, HEX, 10 x 1.5 x 35mm, 10.9, PLT
4	1	EACH	BMC83129	BKT, WELDMT, MAIN BASE, ISL, HDX, '13
3	1	EACH	BMC83125	BKT, WELDMT, ADAPTER PL, ISL, HDX, '13
2	1	EACH	BMC83123	BKT, MAIN, IDLER, WELDMT, ISL, HDX, '13
1	1	EACH	BEL32616	BELT, BANDED B, 2616mm (102")

BILL OF MATERIALS
TRANSARCTIC INC.

1	GENERAL REVISION	8/14/2015	JRR	
0	RELEASED TO PRODUCTION	8/6/2014	JRR	GA
REV	ECN	DESCRIPTION	DATE	BY
			8/6/2014	James Stewart
			8/6/2014	Ron Ingram
			8/6/2014	Dale Mason

THIS DRAWING CONTAINS PROPRIETARY CONFIDENTIAL INFORMATION OWNED BY TRANSARCTIC CANADA INC. THE DOCUMENT AND THE INFORMATION IT IS NOT TO BE USED, DISCLOSED OR REPRODUCED WITHOUT EXPRESS WRITTEN PERMISSION OF THE COMPANY.

UNSPECIFIED TOLERANCES:	ALL DIM	
ONE DECIMAL PLACE (.X)	25	1000
TWO DECIMAL PLACE (.XX)	25	1000
THREE DECIMAL PLACE (.XXX)	25	1000
FRACTIONAL (1/16")	ANGULAR	1/32

THIRD ANGLE PROJECTION

DRAWING UNIT OF MEASURE:	MM (INCH)
SCALE:	1:1

DATE: 8/6/2014
 TITLE: MT KIT, ISL-D 2013, HDX, 05G, 24V, '13
 SIZE: D
 DWG NO: KMC64194
 REV: 1
 SHEET 1 OF 1

TOP VIEW

PARTS REMOVED FOR CLARITY.

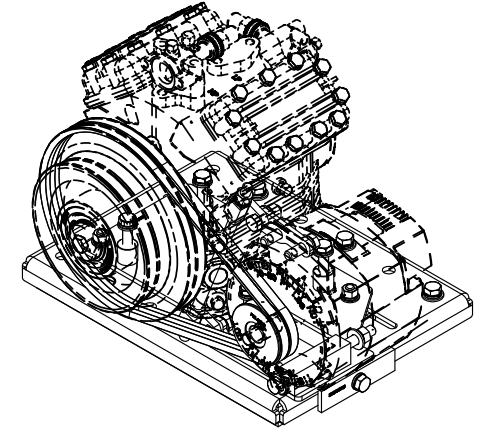
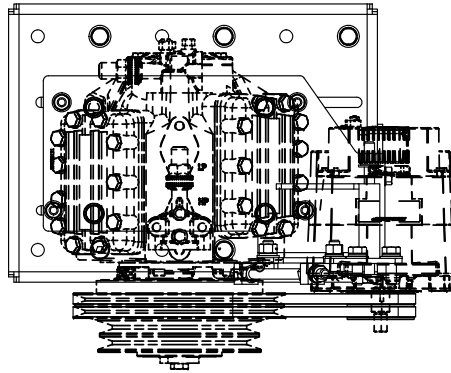
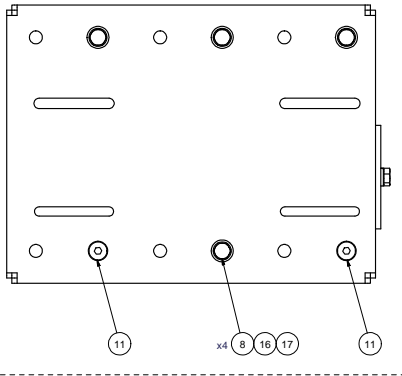

ISOMETRIC VIEW

NOTE:
SHOWING COMPRESSOR
4xFCY OR
FK40 xxx
AS REFERENCE.

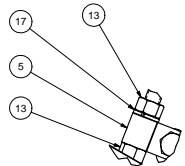
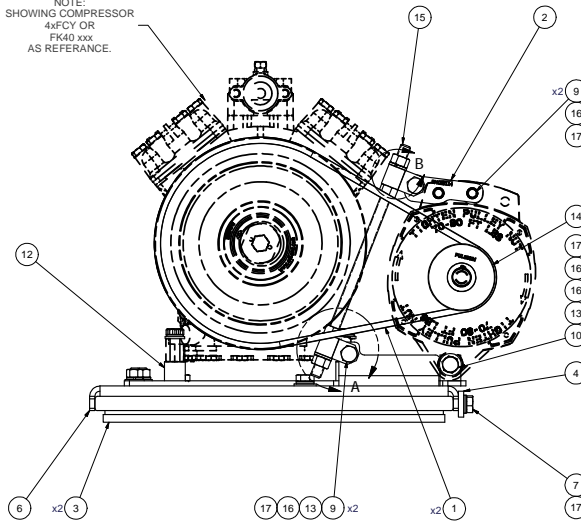

DETAIL B
SCALE 1/2

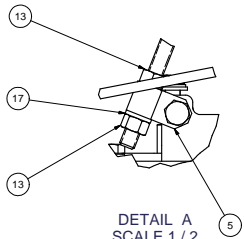

DETAIL A
SCALE 1/2

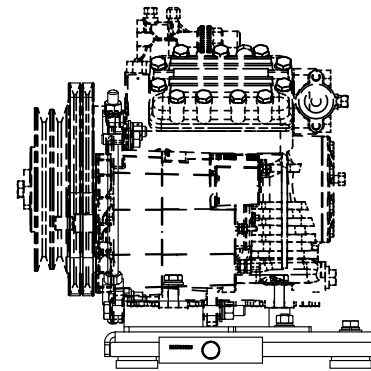

NOTES:

- 1) USE SERVICABLE THREADLOCKER ON ALL FASTENERS TO ENGINE COMPONENTS AND TORQUE ALL BOLTS TO S.A.E. SPECIFICATIONS.
- 2) SEE "TRANSARCtic A/C COMPRESSOR MOUNT INSTALLATION DISCLAIMER".
- 3) WEIGHT: 56.70 LBS.

ITEM	QTY	U/M	PART NUMBER	DESCRIPTION
17	12	EACH	WLO08000	WASHER, LOCK, 1/2", 8, PLT
16	10	EACH	WFO08000	WASHER, FLAT, 1/2", 8, PLT
15	1	EACH	TRD08120	THREADED, ROD, 1/2-13UNC x 12", 5 PLT
14	1	EACH	PUL03321	PULLEY, ALT, IDLER, 3.25"o, 2A
13	7	EACH	NT008000	NUT, HEX, 1/2-13UNC, 8, PLT
12	1	EACH	K8T84094	KIT, PLATFORM, PS, 4xFCY/ FK40, W/ ALT, '13
11	2	EACH	CSF00076	CAPSCREW, FH, 1/2-20UNF x .75", ALLOY, PLT
10	1	EACH	BT008653	BOLT, HEX, 1/2-13UNC x 6.50, 8, PLT
9	4	EACH	BT008150	BOLT, HEX, 1/2-13UNC x 1.50, 8, PLT
8	4	EACH	BT008101	BOLT, HEX, 1/2-20UNF x 1.00, 8, PLT
7	1	EACH	BT008653	BOLT, HEX, 1/2-13UNC x 6.50, 5, PLT, FT
6	1	EACH	BMZ00043	BKT, MAIN, BASE PL, '13
5	2	EACH	BMT10011	BKT, TENR, BLOCK, OFFSET, 3mm
4	1	EACH	BMN80025	BKT, BACK, PL, SLIDE, IC, RE300
3	2	EACH	BMN80008	VIBRATION ISOLATOR, BAR, 16.50 x 2 x 1.50
2	1	EACH	BMCS3114	BKT, PL, ALT, SPACER, T3RE, '13
1	2	EACH	BELT1040	BELT, A, gr, 1040mm (41") (17410)

BILL OF MATERIALS

DRAWN: jrodriquez
CHECKED: Val_Jakowlew

DATE: 9/9/2013

TRANSARCtic INC.

RELEASED TO PRODUCTION: 9/9/2013

REVISION: DESCRIPTION: DATE: BY: JAMES STEWART

APPROVED: Ron Ingram

DATE: 9/9/2013

UNSPECIFIED TOLERANCES: .001 INCH

ONE DECIMAL PLACE (.X) .001 INCH

TWO DECIMAL PLACES (.XX) .0005 INCH

THREE DECIMAL PLACES (.XXX) .0001 INCH

FRACTIONAL (1/16") .001 INCH

TITLE

DATE: 9/9/2013

APPROVED: DATE: 9/9/2013

SIZE: D

SCALE: 1:3

KIT, COMPRESSOR, 24V, PS, FK40/4xFC, '13

DWG NO: KCB84094

REV: 0

SHEET 1 OF 1

DRAWING UNIT OF MEASURE: MM (INCH)

THIRD ANGLE PROJECTION

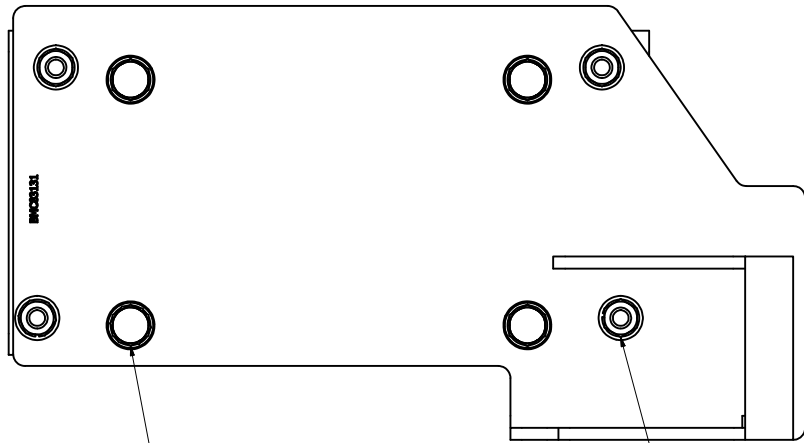

NOTE:
USE 40mm OR 60mm LONG
BOLT(S) DEPENDING ON
COMPRESSOR BODY STYLE.

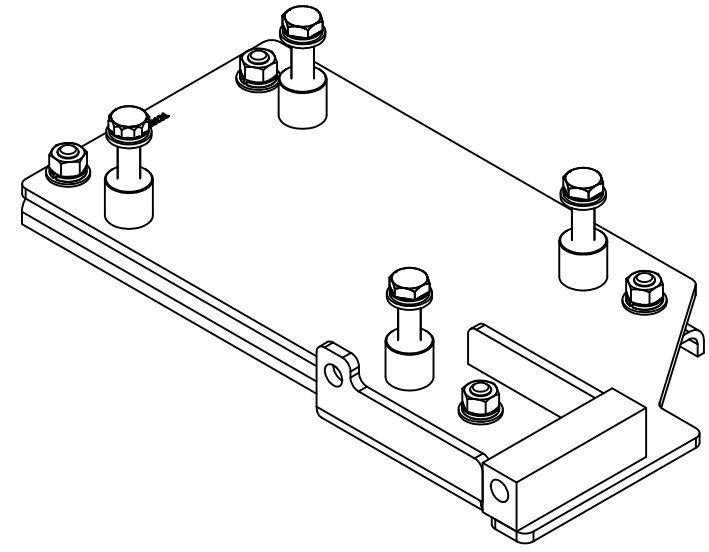

ISOMETRIC VIEW

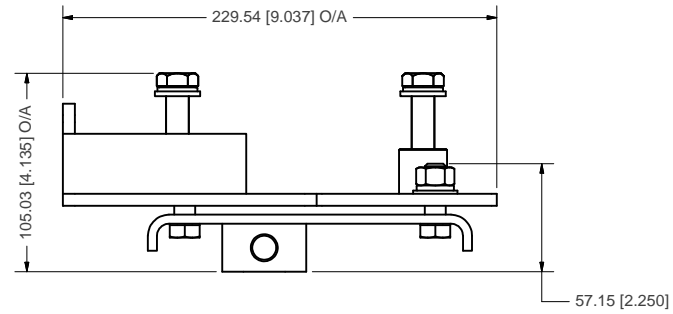
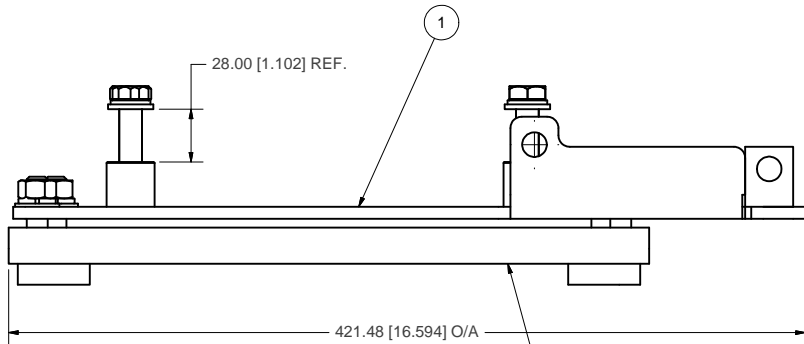

ITEM	QTY	U/M	PART NUMBER	DESCRIPTION
9	4	EACH	WLP07000	WASHER, LOCK, 7/16", 5, PLT
8	4	EACH	WLA12000	WASHER, LOCK, 12mm, 8.8, PLT
7	4	EACH	WFN07000	WASHER, FLAT, 7/16", 2, PLT
6	4	EACH	WFA12000	WASHER, FLAT, 12mm, 8.8, PLT
5	4	EACH	NTP07000	NUT, HEX, 7/16-14UNC, 5, PLT
4	4	EACH	BTC12060	BOLT, HEX, 12 x 1.75 x 60mm, 10.9, PLT
3	4	EACH	BTC12040	BOLT, HEX, 12 x 1.75 x 40mm, 10.9, PLT
2	1	EACH	BMN80031	BKT, MAIN, SLIDE, ASSY, 05K, IC, RE300
1	1	EACH	BMC83131	BKT, WELDM'T, 4xFCY W/ALT, P-S, HDX, '13



DRAWN	9/5/2013
Jrodriguez	
CHECKED	9/5/2013
Val Jakowlew	
OA	
MFG	9/5/2013
Ron Ingram	
APPROVED	9/5/2013
Dale Mason	

TITLE
**KIT, PLATFORM, PS, 4xFCY/ FK40, W/
ALT, '13**

SIZE	C	DWG NO	KBT84094	REV	0
SCALE	1:2	SHEET	1	OF	1

- NOTES:
- 1) USE SERVICABLE THREADLOCKER ON ALL FASTENERS TO ENGINE COMPONENTS AND TORQUE **ALL** BOLTS TO S.A.E. SPECIFICATIONS.
 - 2) SEE "TRANSARCTIC A/C COMPRESSOR MOUNT INSTALLATION DISCLAIMER".
 - 3) WEIGHT: 18.22 LBS.

0	ADDED 4x BTC12040 BOLTS.	6/5/2014	JRR
A	RELEASED TO PROTOTYPE.	9/5/2013	JRR
REV/ECN:	DESCRIPTION:	DATE:	BY:
THIS DRAWING CONTAINS PROPRIETARY CONFIDENTIAL INFORMATION OWNED BY TRANSARCTIC CANADA INC. THE DOCUMENT AND THE INFORMATION IN IT ARE NOT TO BE USED, DISCLOSED OR REPRODUCED WITHOUT EXPRESS WRITTEN PERMISSION OF THE COMPANY.			
UNSPECIFIED TOLERANCES: (ALT. DIM.)		THIRD ANGLE PROJECTION	
ONE DECIMAL PLACE (.X)	.50 [0.020]		
TWO DECIMAL PLACE (.XX)	.25 [0.010]		
THREE DECIMAL PLACE (.XXX)	.10 [0.005]		
FRACTIONAL +/- .002"	ANGULAR +/- .50°	DRAWING UNIT OF MEASURE: MM [INCH]	

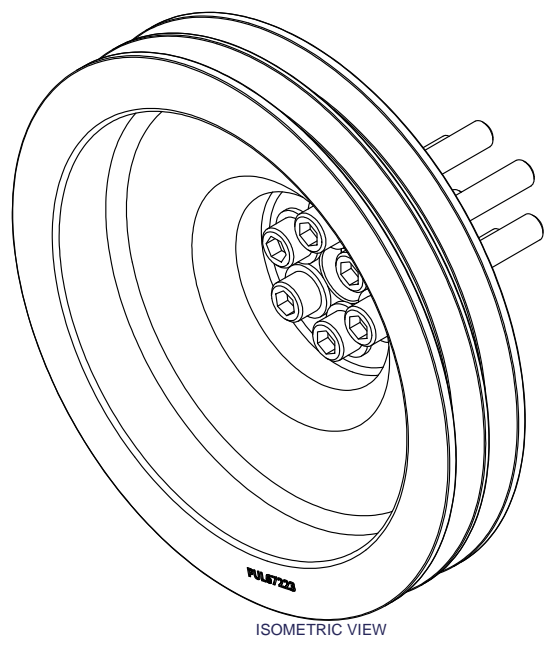
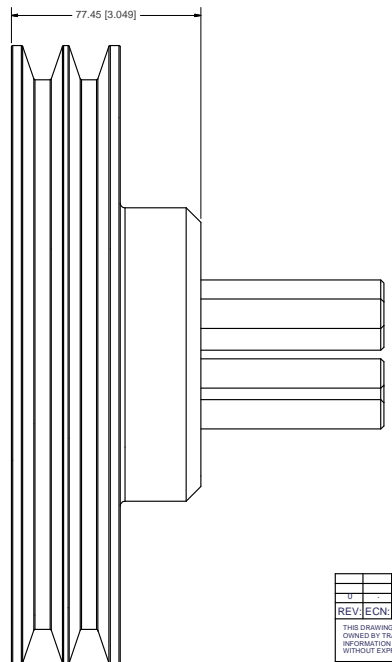
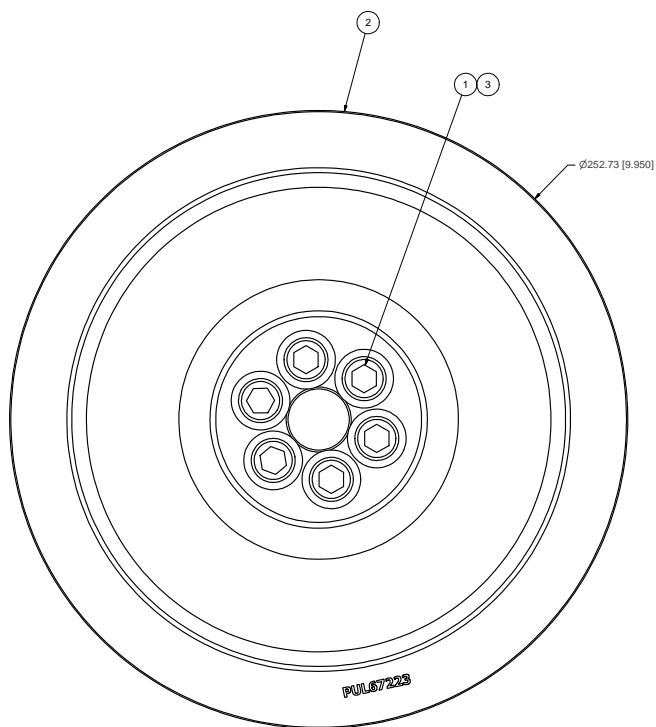
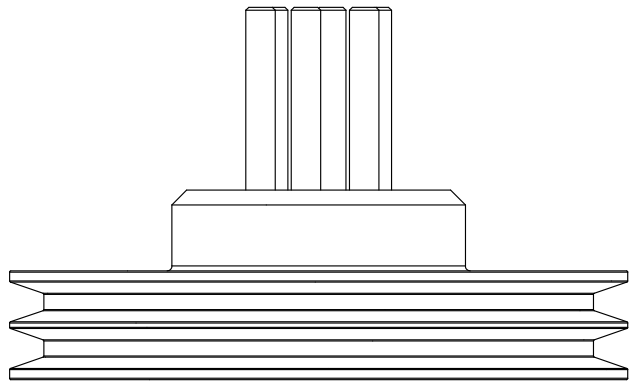

- NOTES:**
- 1) USE SERVICABLE THREADLOCKER ON ALL FASTENERS TO ENGINE COMPONENTS AND TORQUE **ALL BOLTS** TO S.A.E. SPECIFICATIONS.
 - 2) SEE "TRANSARGTIC A/C COMPRESSOR MOUNT INSTALLATION DISCLAIMER".
 - 3) WEIGHT: 13.24 LB

ITEM	QTY	U/M	PART NUMBER	DESCRIPTION
3	6	EACH	WFS12002	WASHER, FLAT, HDN, 12mm, STL, BLK
2	1	EACH	PUL67223	Pulley, Crank, ADD-ON, 10"Ø, ISB, 2B/A, '13
1	6	EACH	CSS12090	CAPSCREW, SH, 12 x 1.25 x 90mm, 12.9, PLT

TRANSARGTIC INC.

U	RELEASED TO PRODUCTION	11/6/2013	JRR
REV	DESCRIPTION	DATE	BY
1	Kit	10/21/2008	James Stewart
2	Kit	11/6/2013	Ron Ingram
3	Kit	11/6/2013	Dale Mason

UNSPECIFIED TOLERANCES: ALL DIM (MM)
 ONE DECIMAL PLACE (X1) .05 (FRA)
 TWO DECIMAL PLACE (X2) .02 (FRA)
 THREE DECIMAL PLACE (X3) .01 (FRA)
 FRACTIONAL (X1/16) ANGULAR ± .25°



DRAWN	Jose Rodriguez	7/21/2014
CHECKED	Val Jakowlew	11/6/2013
APPROVED	Dale Mason	11/6/2013
TITLE	KIT, PULLEY, 2B, ISB, 2013	
SIZE	D	DWG NO
SCALE	1:1	KPC64194
DRAWING UNIT OF MEASURE	MM (INCH)	REV
		0
		SHEET 1 OF 1

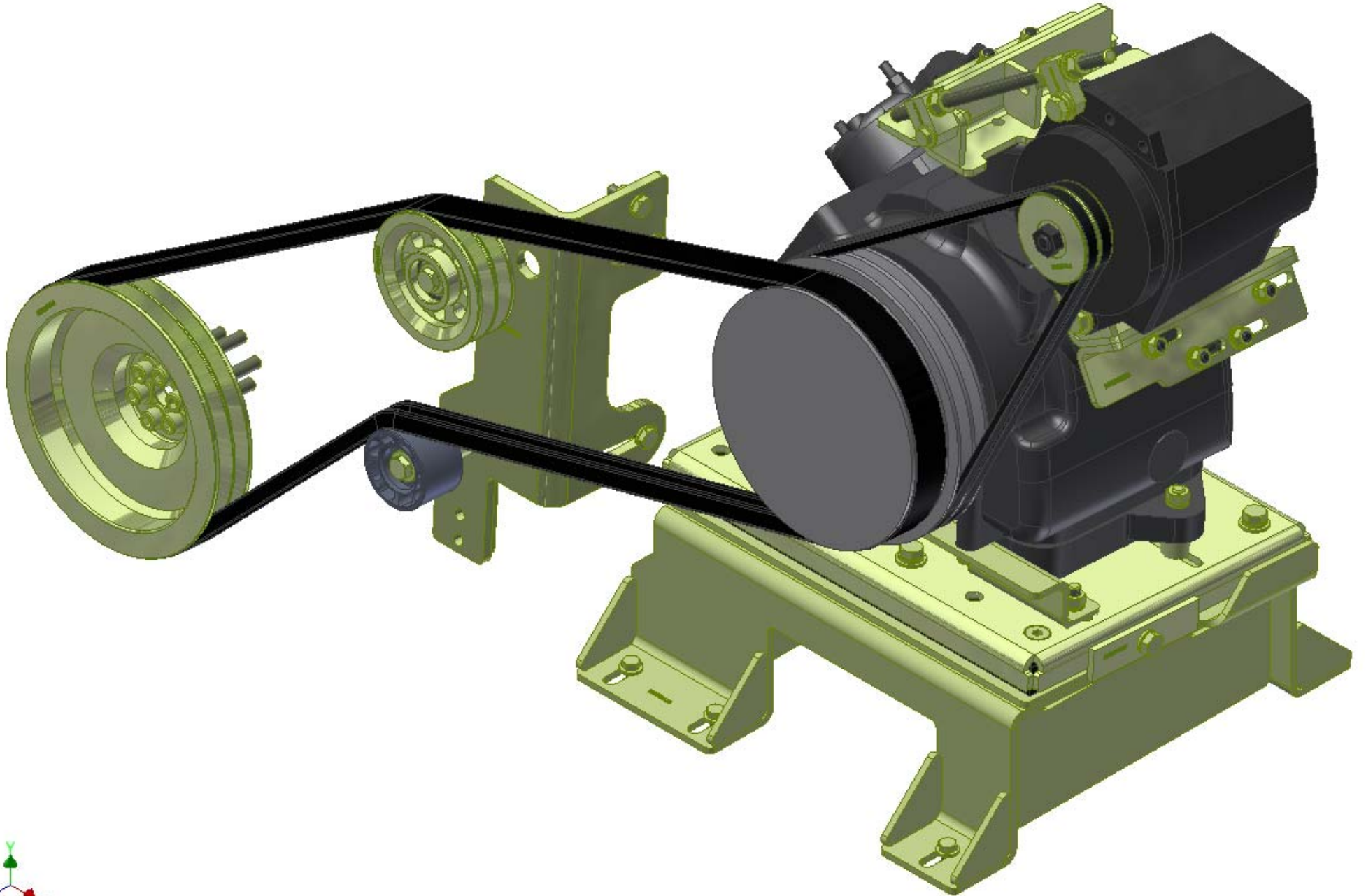

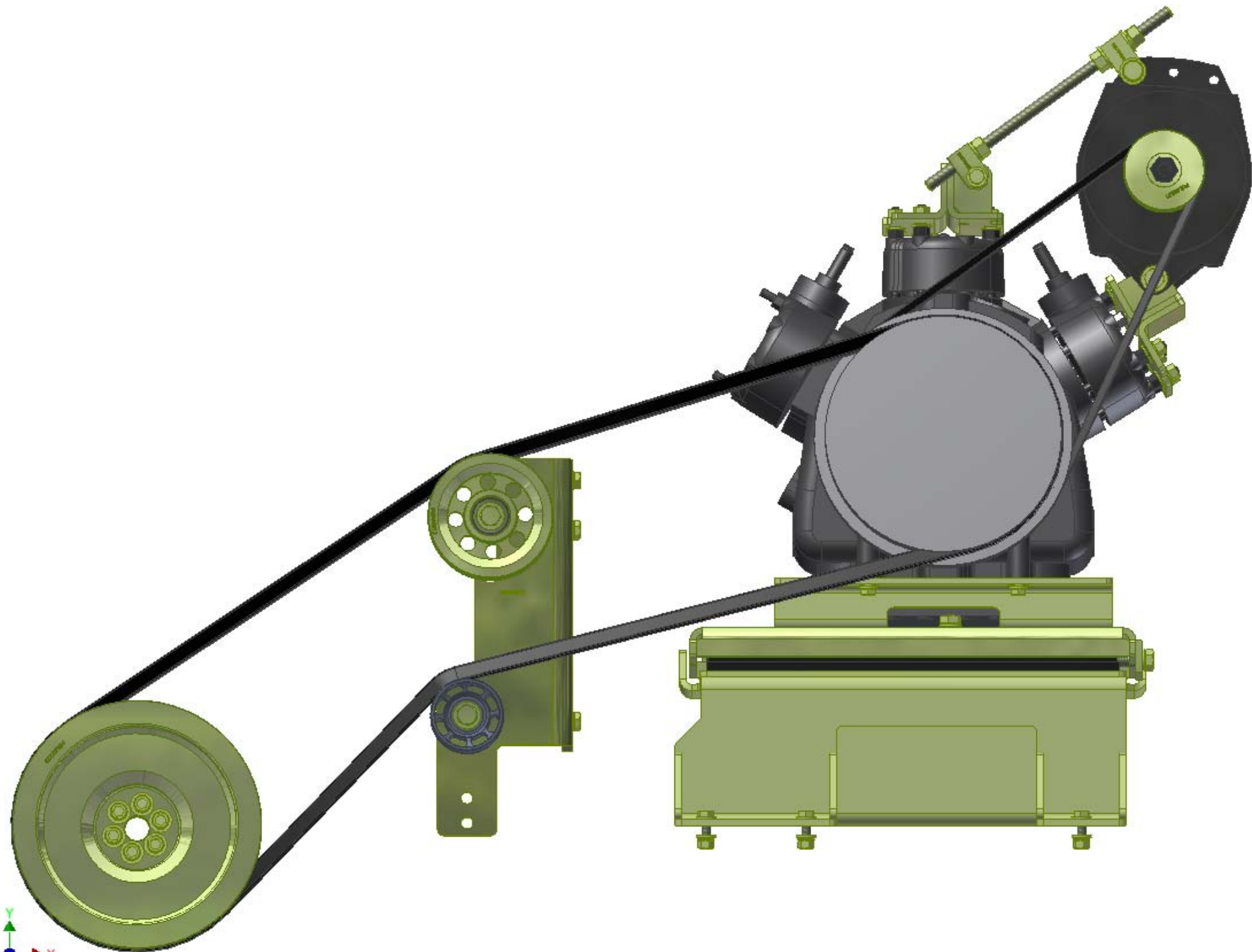

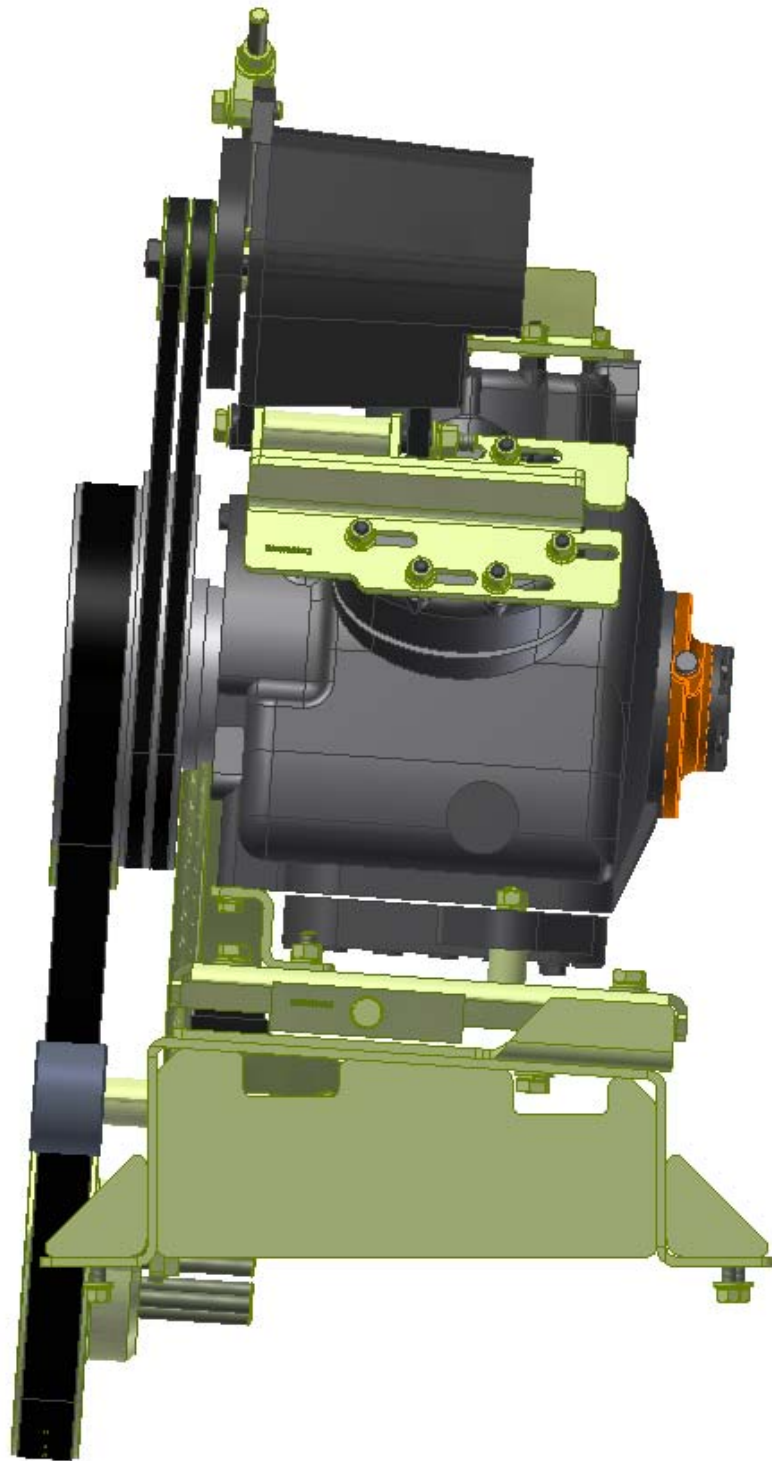

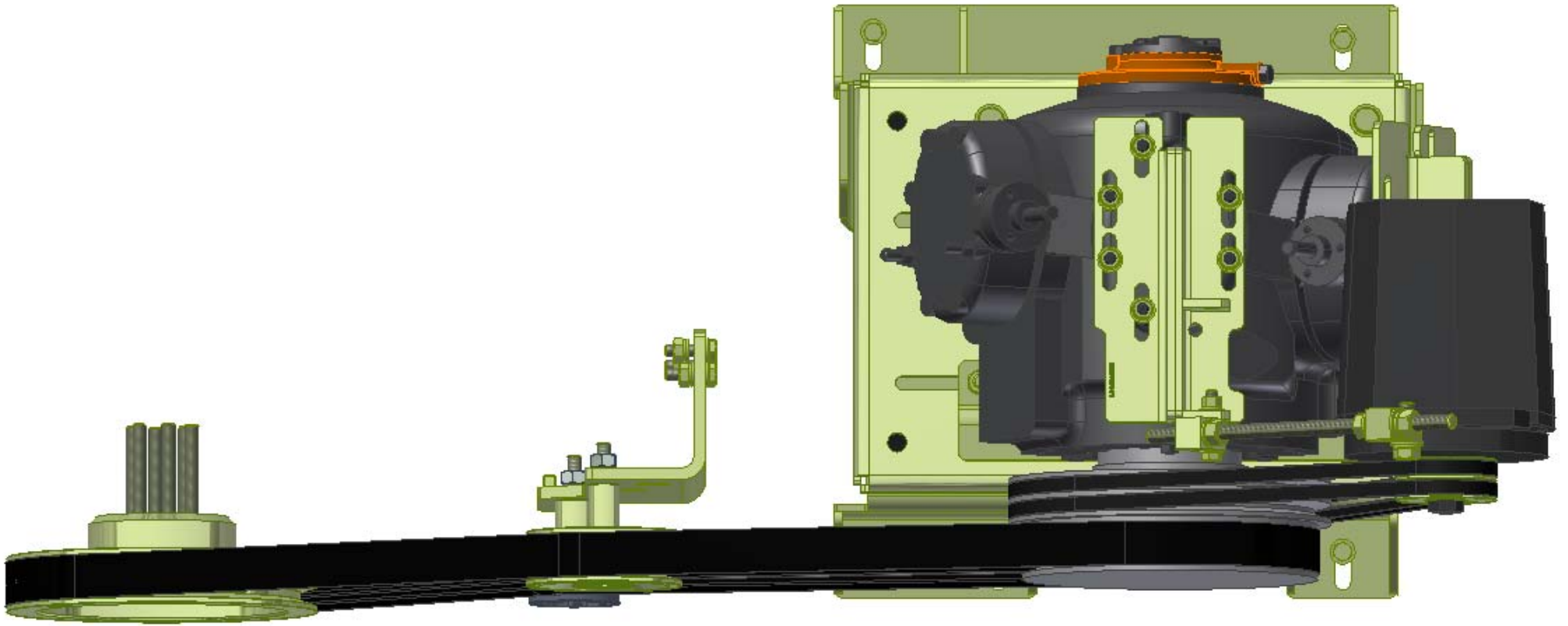

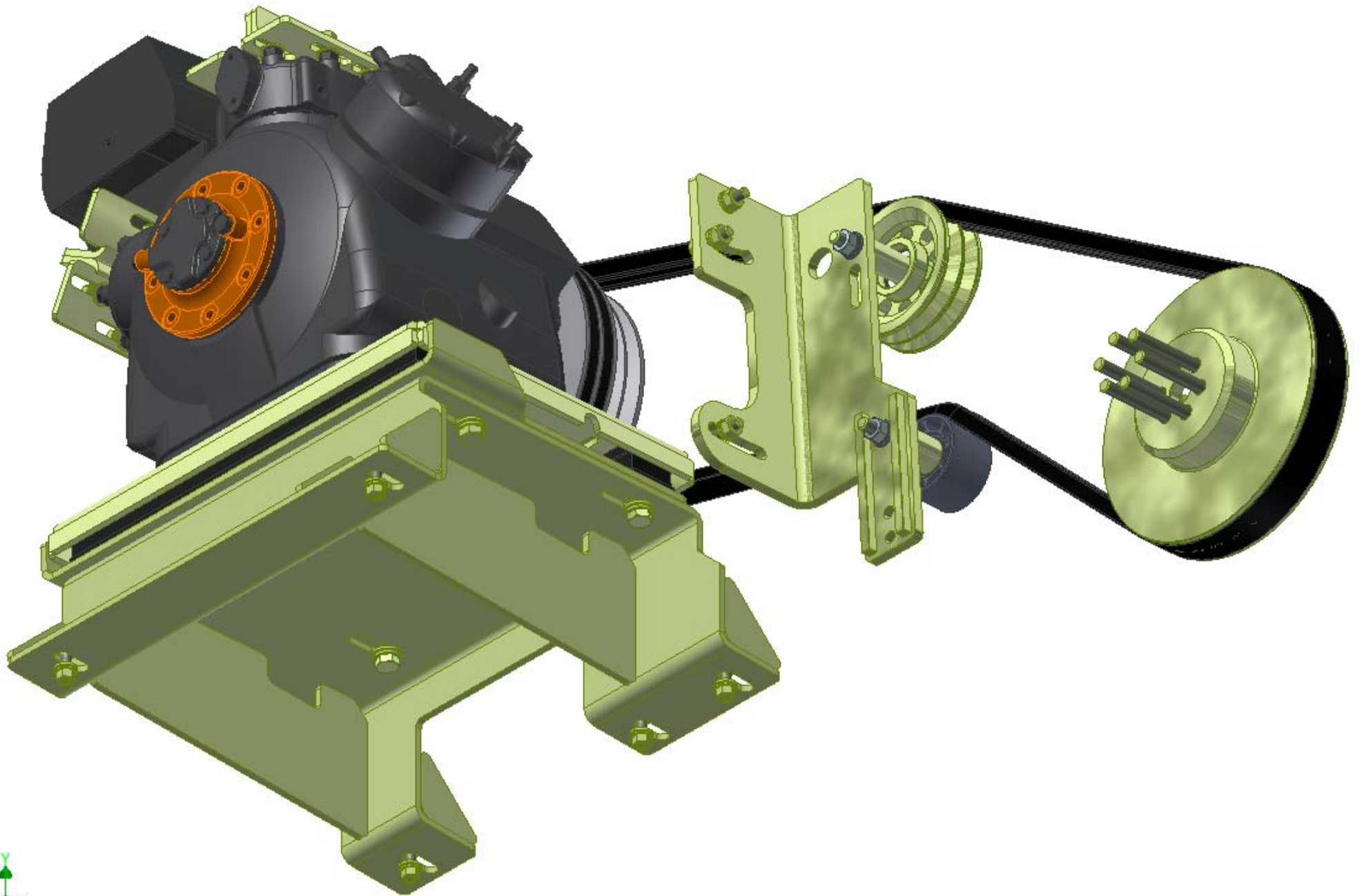

TransArctic A/C Compressor Mount Installation Disclaimer

All compressor mounts should be installed by qualified and trained personnel using proper tools and equipment in safe working conditions following industry standard guidelines for motor vehicle service and repair.

The installer of any compressor mount purchased from TransArctic must undertake all responsibility of issues arising from that compressor bracket being installed on any vehicle. As well as insure that a **proper and sufficient ground** is established between the compressors' clutches and the vehicle's engine. Mount functionality, operation and durability can all be compromised by an incompetent installation.

Due to the many different situations, parameters and application criteria, which are beyond the compressor mount manufacturer's control, TransArctic does not warrant design, durability, or operational functionality of any compressor mount improperly installed by another party.

With no implied guarantees it is the mount installer's strict responsibility to determine safety and functionality, of the compressor mount, at the time of installation.

Please contact TransArctic with any issue arising from installation so we may better improve the product. If you have any reservations about the compressor mount integrity contact TransArctic immediately at 1-877-COLD-AIR.

Mark OEM tensioner location

Install Kit

Check for Interferences

Check to ensure that the proper OEM tensioner orientation is maintained

Run engine with A/C system engaged for at least 10 minutes to run in belt

Check OEM tensioner orientation and adjust as required

Responsabilidad limitada de TransArctic en la instalación del soporte del compresor

Todos los soportes de los compresores deben ser instalados por personas calificadas y entrenadas, usando para ello los equipos y herramientas necesarios para esta labor en buenas condiciones y según las normas y guías para el servicio y/o reparación de motores de vehículos.

El instalador de los soportes comprados en TransArctic asume toda la responsabilidad de cualquier problema que surga en el soporte del compresor al vehículo; de igual manera es responsable que el cable a tierra sea conectado entre el embrague del compresor y el motor del vehículo.

Se advierte que el buen funcionamiento y la durabilidad del soporte pueden ser comprometidos por defectos en su instalación.

Debido a las diversas situaciones que se puedan presentar fuera del control del fabricante, TransArctic no garantiza el diseño, la durabilidad o el correcto funcionamiento de cualquier equipo inapropiadamente instalado por terceros.

Esta sobreentendido que el Instalador del montaje del compresor es estrictamente responsable de la seguridad y funcionamiento del equipo en el momento de la instalación.

Si tuviera algún problema o duda acerca de la instalación del soporte del compresor pongase en contacto inmediatamente con TransArctic al teléfono 1-877-COLD-AIR de modo que podamos mejorar nuestro producto.

Note la ubicación del medidor de tensión OEM

Instale el equipo

Controlar si hay interferencias.

Asegurese que el medidor de tensión mantenga la orientación justa.

Encienda el motor por lo menos 10 minutos con el sistema A/C enganchado para que la correa corra

Controle la orientación justa del medidor de tensión y ajuste a las condiciones requeridas del fabricante