

Bill of Materials Listing

11/30/2009

TransArctic Canada Inc.

Page 1 of 1

Product Number	Description	Date	Weight	Uof M	Yield
Line Component Prod#	Description	Bin Unit	Qty	Cost	Extension
KMK72652	Mt Kit, C7, A3FE, 2 TM-21, 2A, '07		8/23/2007	73.54	0
10 BEL11125	Belt, A gr, 1125mm (44.3") (17443)		each	2	6.49
20 BMK70075	Bkt, X-mem, Weldmt, C7, A3FE, 07		each	1	75.00
30 BMK70079	Bkt, Main, Weldmt, D/S, C7, A3FE, 07		each	1	94.65
40 BMK70082	Bkt, Main, Weldmt, P/S, C7, A3FE, 07		each	1	78.05
50 FSP78573	SPACER, FAN, PULLEY, C7, 85.73mm(3.375")		each	1	32.00
55 FTS10198	Fitting, Manifold,GMpadMount,VOR,dwn,MIO		each	1	27.25
60 PUL10094	Pulley, Idler, SA,94d x 18w,Blk (IP-103)		each	2	4.99
70 PUL70012	Pulley, Crank, C7, 2A, 8" DIA		each	1	125.00
80 SCD09010	Spacer, Col, Drl, 9mm x 25.4o x10.32i		each	2	2.20
90 SLV17040	Sleeve, Pulley, 16.9o x 14.29mm x 10.08i		each	2	5.28
100 TEN00002	Tenr, Spring, Un-Direct, 90d, 3/8 x 4.5"/3.5"		each	1	44.63
110 TEN00006	Tenr, Spring, Un-Direct, 90d, 3/8 x 2.5"		each	1	49.29
112 HOR01301	Hose, RAD, Crvd, Sht"U", 1.25" ID(72205)		each	1.00	13.58
114 HOR01302	Hose, RAD, Curved, Lg 90, 1.25" ID(cut71425)		each	1.00	8.13
116 TUS01304	Tube, Stl, Exh, 1.25"o.d., Straight, 4.0"		each	2	1.50
118 CLP20001	Clamp, Gear, #20, 3/4-1 3/4 (19/44mm), S		each	4	0.61
120 KBK72652	Bag Kit, Fasteners, KMK72652/2052		each	1	17.36

TEN00002 to be set-up as CW rotation @ 3.5" CTL base to CTL pulley.
(Drill hole @ 1".)

608.30

Bill of Materials Listing

TransArctic Canada Inc.

12/7/2007
Page 1 of 1

Product Number		Description	Bin	Date	Weight	Uof M	Yield
Line	Component Prod#	Description		Unit	Qty		
KBK72652		Bag Kit, Fasteners, KMK72652/2052		08/22/07	3.92		0
10	BTC08100	Bolt, Hex, 8 x 1.25 x 100mm, 10.9, Plt		each	8		
20	BTC10060	Bolt, Hex, 10 x 1.5 x 60mm, 10.9, Plt		each	8		
30	BTC10110	Bolt, Hex, 10 x 1.5 x 110mm, 10.9, Plt		each	4		
40	BTC14040	Bolt, Hex, 14 x 2 x 40mm, 10.9, Plt		each	4		
50	BTC14050	Bolt, Hex, 14 x 2 x 50mm, 10.9, Plt		each	2		
60	CSF06250	Capscrew, FH, 3/8-16 x 2.5", Alloy, Plt		each	2		
70	CSF10046	Capscrew, FH, 10 x 1.5 x 45mm, 10.9,Plt		each	2		
80	CSF14031	Capscrew, FH, 14 x 2 x 30mm, 10.9,Plt		each	1		
90	NTA10000	Nut, Hex, 10 x 1.5, 8.8, Plt		each	2		
100	PNS04012	Pin, Spring, 1/4" d x 3/4" lg, ST, PLT		each	2		
110	WFA08000	Washer, Flat, 8mm, 8.8, Plt		each	8		
120	WFA10000	Washer, Flat, 10mm, 8.8, Plt		each	12		
130	WLA08000	Washer, Lock, 8mm, 8.8, Plt		each	8		
140	WLA10000	Washer, Lock, 10mm, 8.8, Plt		each	6		
150	WLA14000	Washer, Lock, 14mm, 8.8, Plt		each	6		

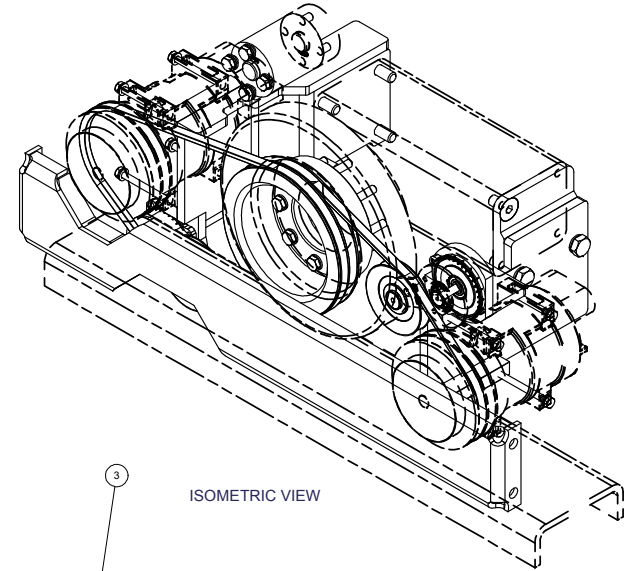
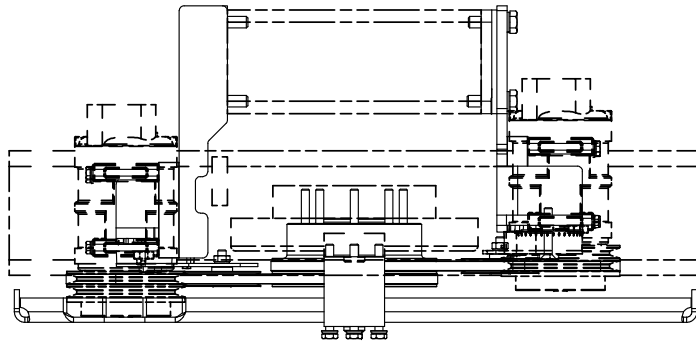

ISOMETRIC VIEW

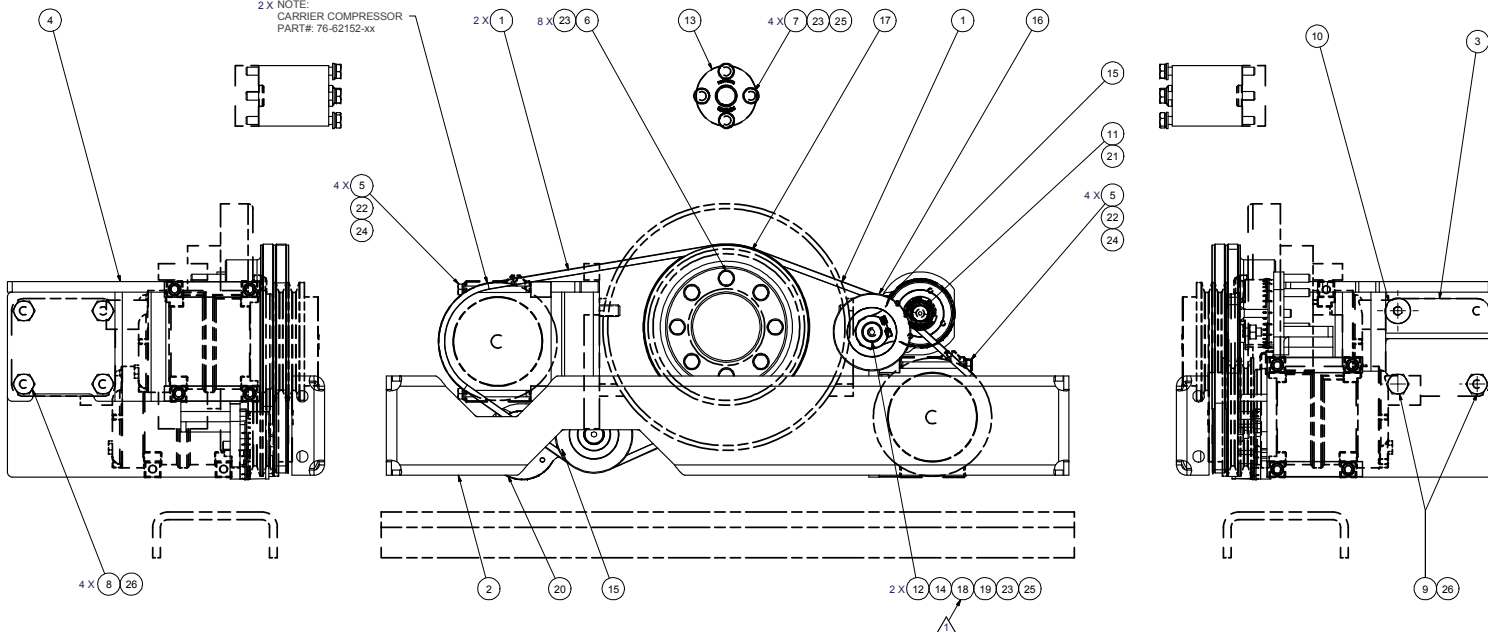

2 X NOTE:
CARRIER COMPRESSOR
PART#: 76-62152-xx

NOTES:

- 1) USE SERVICABLE THREADLOCKER ON ALL FASTENERS TO ENGINE COMPONENTS AND TORQUE ALL BOLTS TO S.A.E. SPECIFICATIONS.
- 2) SEE "TRANSARGTIC A/C COMPRESSOR MOUNT INSTALLATION DISCLAIMER".
- 3) MODIFY EXISTING UPPER RADIATOR HOSE (90 DEG. ELBOW) ON PASSENGER SIDE (TO CLEAR TOP OF COMPRESSOR BEING INSTALLED.) BY REMOVING HOSE ELBOW AND CUTTING 1/2" OFF THE "ENGINE END" AND THEN RE-INSTALL THE "CUT END" BACK ON THE ENGINE FITTING.

26	6	EACH	WLA14000	WASHER_LOCK, 14mm, 8.8, PLT
25	6	EACH	WLA10000	WASHER_LOCK, 10mm, 8.8, PLT
24	8	EACH	WLA08000	WASHER_LOCK, 8mm, 8.8, PLT
23	12	EACH	WFA10000	WASHER_FLAT, 10mm, 8.8, PLT
22	8	EACH	WFA08000	WASHER_FLAT, 8mm, 8.8, PLT
21	1	EACH	TEN00006	TENR. SPRING, UN-DIRECT, 90D, 3/8 X 2.5"
20	1	EACH	TEN00002	TENR. SPRING, UN-DIRECT, 90D, 3/8 X 3.5"
19	2	EACH	SLV17040	SLEEVE, PULLEY, 16.9x14.23mm x 10.08
18	2	EACH	SCD09010	SPACER, COL, DRL, 9mm x 25.4x10.32
17	1	EACH	PUL70012	PULLEY, IDLER, CRANK, C7, 2A, 8" DIA
16	2	EACH	PUL10094	PULLEY, IDLER, SA.94D X 18W.BLK (IP-103)
15	2	EACH	PNS04012	PIN, SPRING, 1/4" D x 3/4" L
14	2	EACH	NTA10000	NUT, HEX, 10 x 1.5, 8.8, PLT
13	1	EACH	FSP78573	SPACER, FAN, PULLEY, C7, 85.73mm (3.375")
12	2	EACH	CSF10046	CAPSCREW, FH, 10 x 1.5 x 45mm, 10.9, PLT
11	2	EACH	CSP06250	CAPSCREW, FH, 3/8-16 x 2.5", 9, PLT
10	1	EACH	CFS14031	CAPSCREW, FH, 14 x 2 x 30mm, 10.9, PLT
9	2	EACH	BTC14050	BOLT, HEX, 14 x 2.0 x 60mm, 10.9, PLT
8	4	EACH	BTC14040	BOLT, HEX, 14 x 2 x 40mm, 10.9, PLT
7	4	EACH	BTC10110	BOLT, HEX, 10 x 1.5 x 110mm, 10.9, PLT
6	8	EACH	BTC10060	BOLT, HEX, 10 x 1.5 x 60mm, 10.9, PLT
5	8	EACH	BTC08100	BOLT, HEX, 8 x 1.25 x 100mm, 10.9, PLT
4	1	EACH	BMK70082	BKT, MAIN, WELDMT, DIS, C7, A3FE, 07
3	1	EACH	BMK70079	BKT, MAIN, WELDMT, DIS, C7, A3FE, 07
2	1	EACH	BMK70075	BKT, X-MEM, WELDMT, C7, A3FE, 07
1	2	EACH	BEL11125	BELT, A gr, 1125mm (44.3")

1	WAS SCD12710	12/12/008	JRR	
0	RELEASED TO PRODUCTION	12/07/07	VAL	OK
REV	ECN	DESCRIPTION	DATE	BY
				James Stewart
				WFG
				Val Jakowlew
				APPROVED
				Dale Mason
				12/7/2007

DRAWN	12/7/2007
WJK	
CHECKED	
Ron Ingram	12/7/2007
TITLE	
DATE	12/07/07
BY	James Stewart
WFG	
Val Jakowlew	12/7/2007
APPROVED	
Dale Mason	12/7/2007

TRANSARGTIC INC.

MT KIT, C7, A3FE, 2 TM-21, 2A, '07

SIZE: D

DWG NO: KMK72652

REV: 1

SCALE: 1:3

SHEET 1 OF 1

UNSPECIFIED TOLERANCES:	
ONE DECIMAL PLACE (0.1)	MM
TWO DECIMAL PLACE (0.05)	MM
THREE DECIMAL PLACE (0.025)	MM
FRAC TIONS (1/32)	INCHES
FRAC TIONS (1/64)	INCHES



DRAWING UNIT OF MEASURE	MM (INCH)
-------------------------	-----------

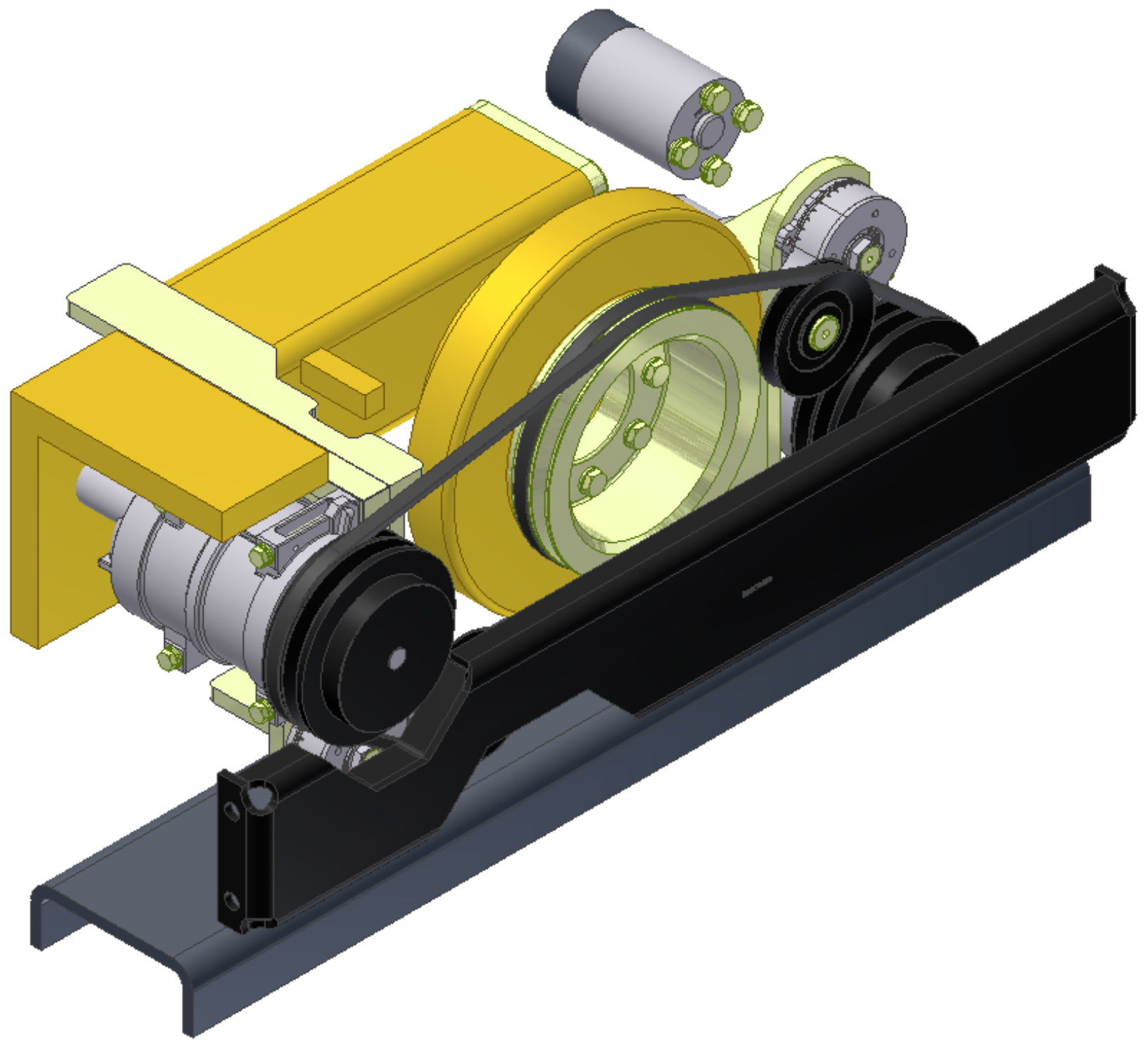

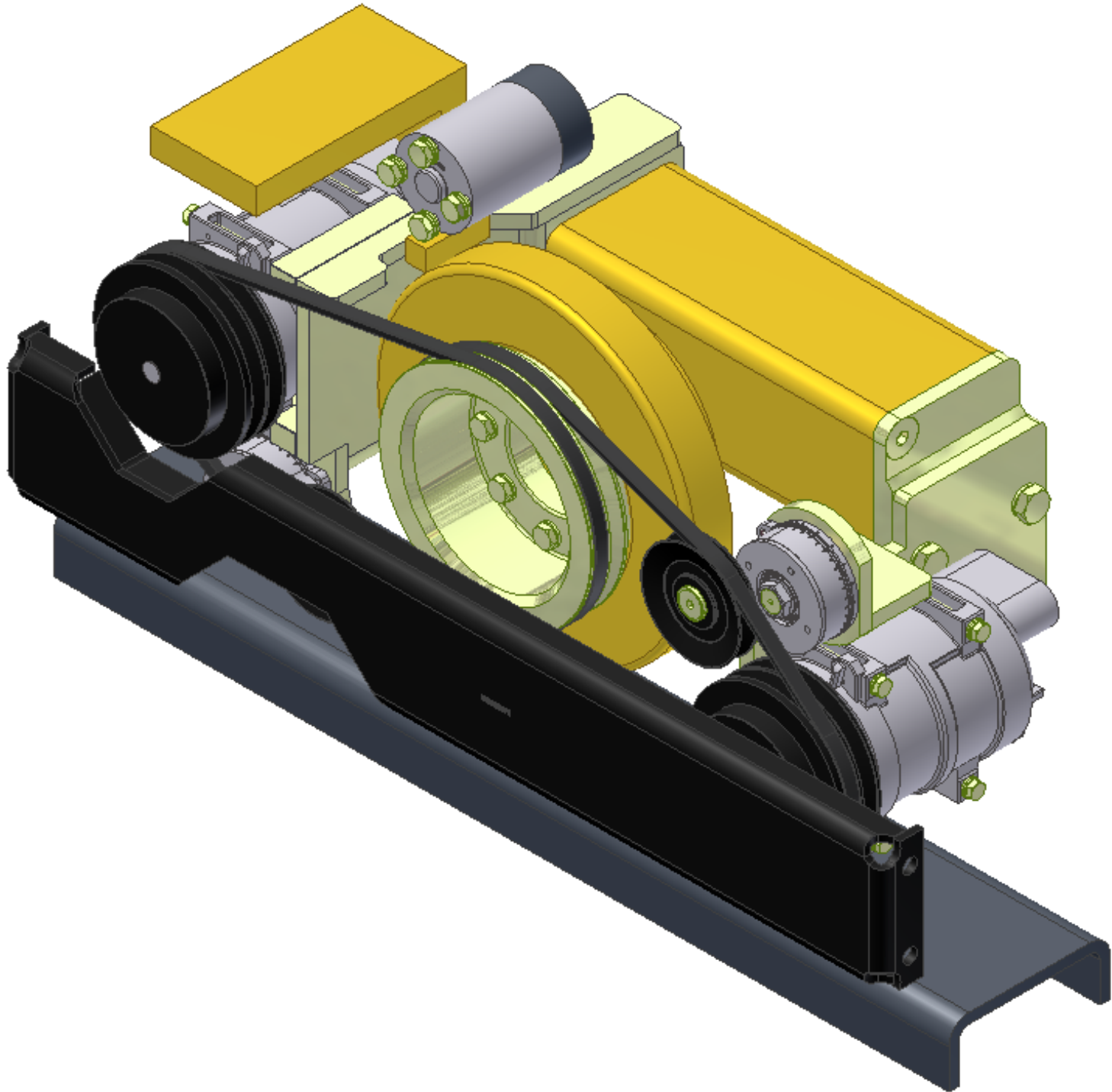

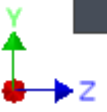
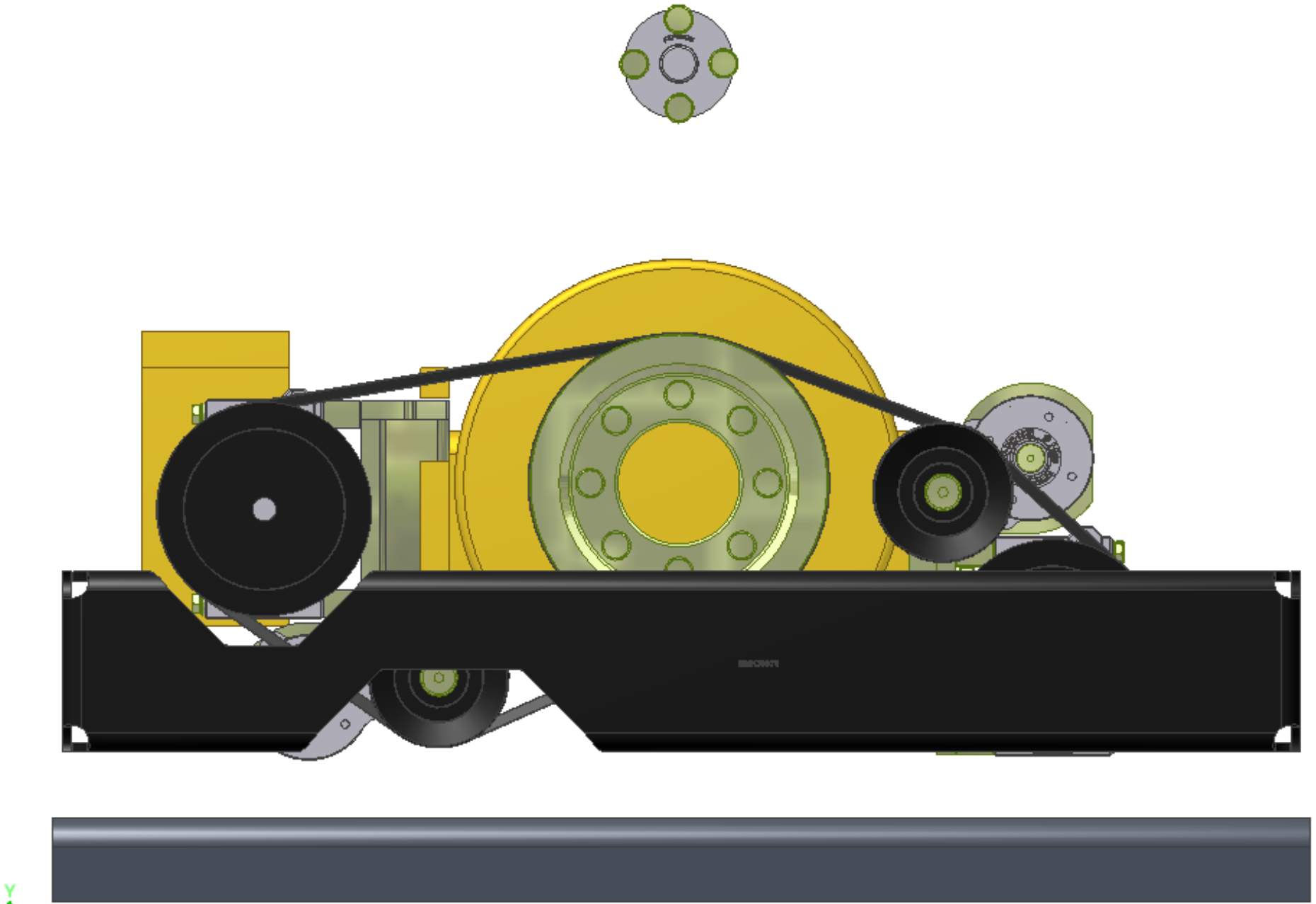

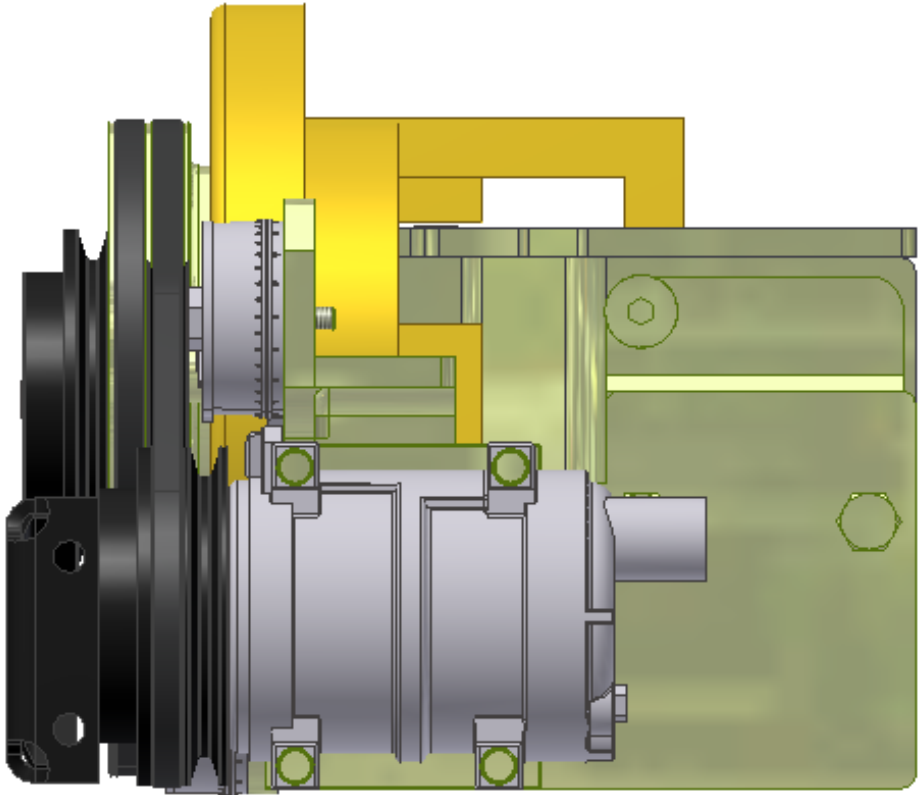
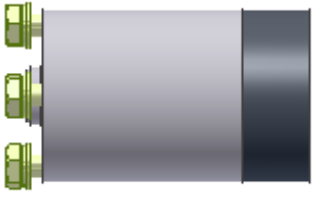

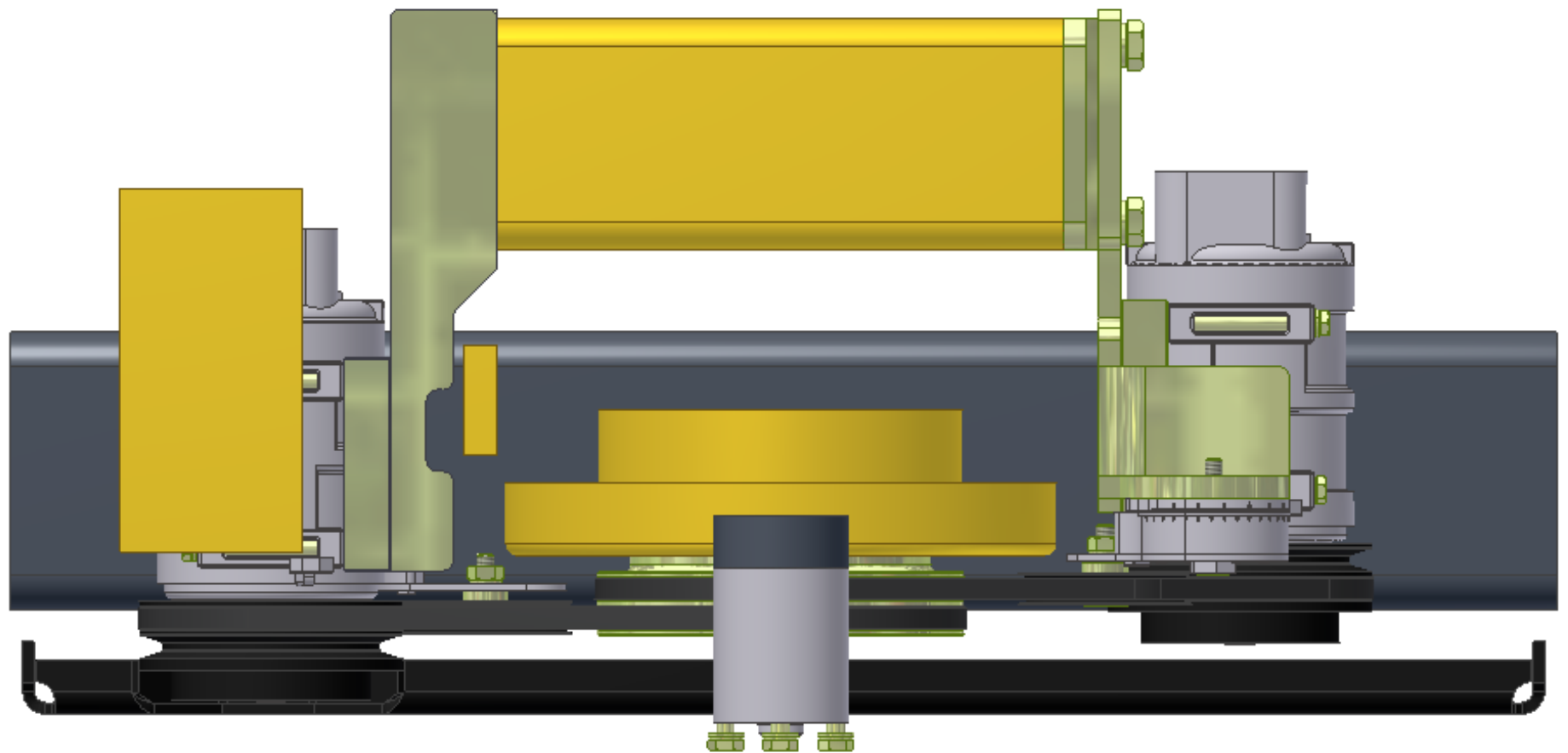



-MODIFY EXISTING OVERFLOW BOTTLE RAD HOSE & HOR01302 AS SHOWN. (CUT +/- 6" OFF OF THE 90 DEG. END OF HOR01302 HOSE.)

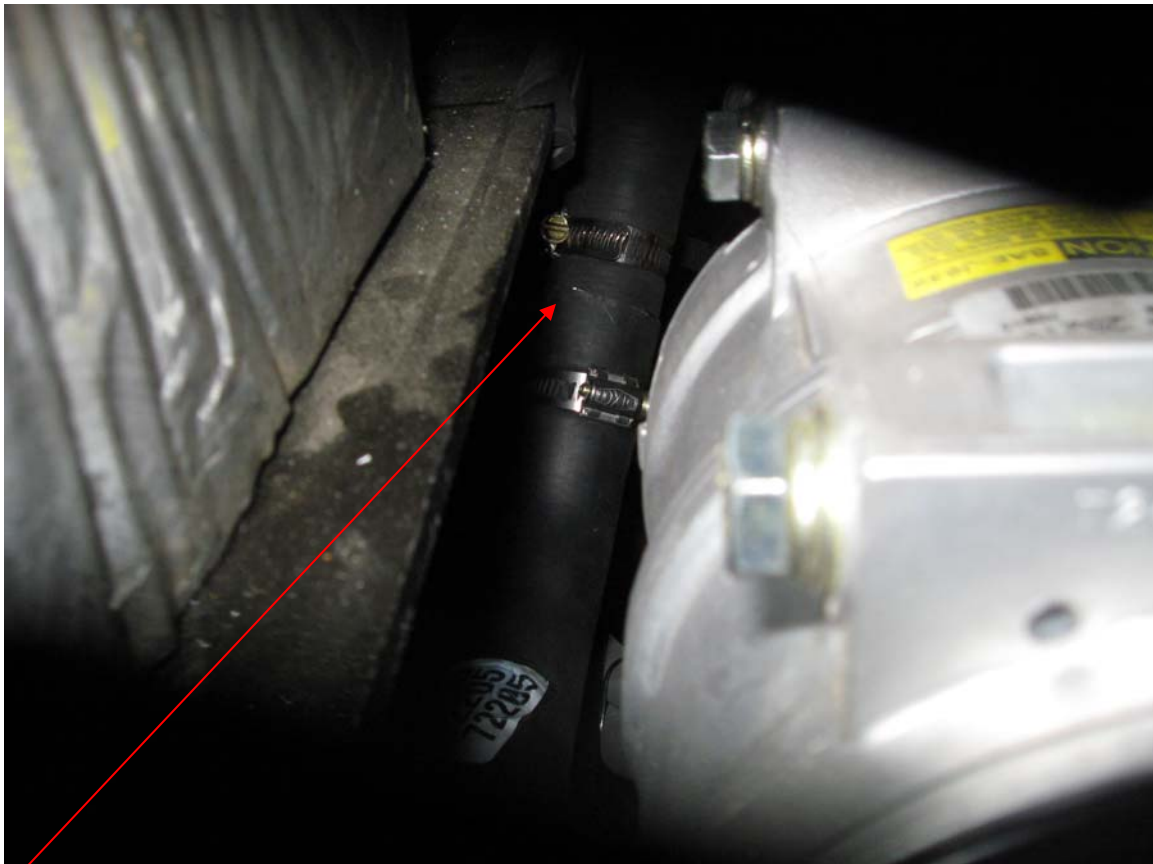

- MODIFY HOR01302 AS SHOWN IN THE ABOVE PICTURES TO SUIT PROPER INSTALLATION.)

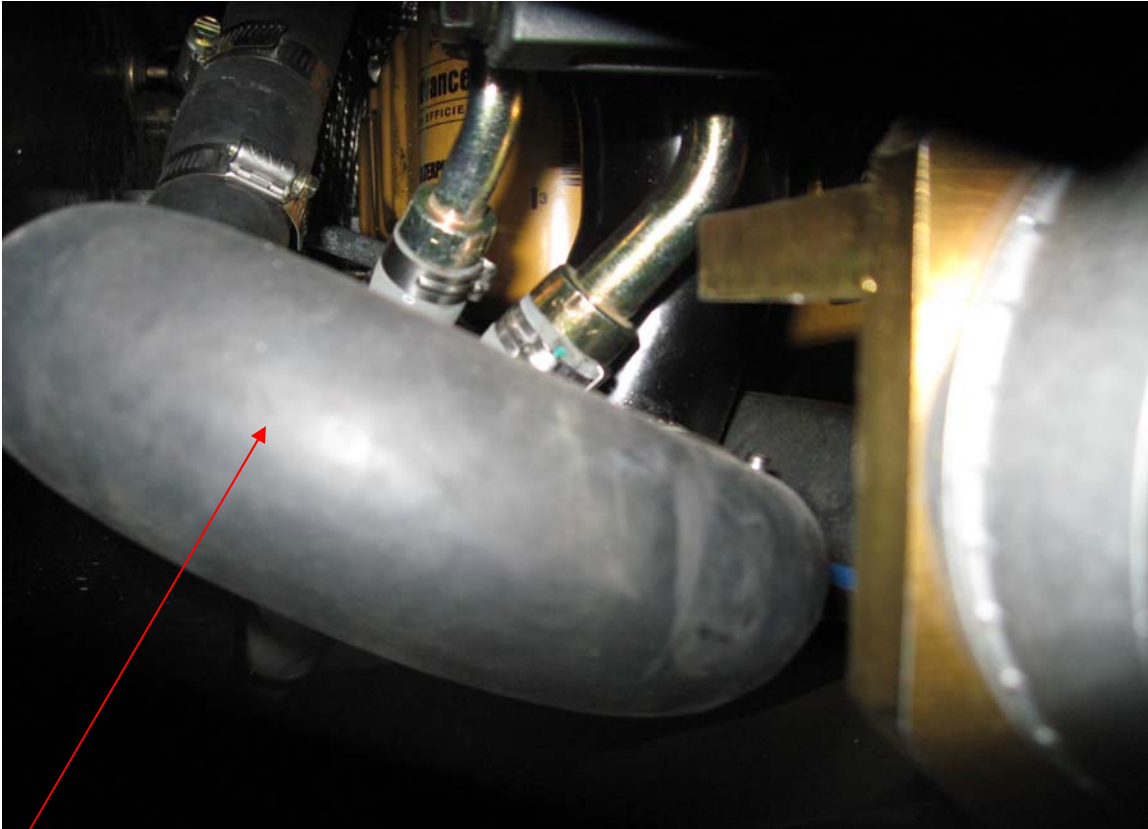

- USE HOR01301 AS IS.

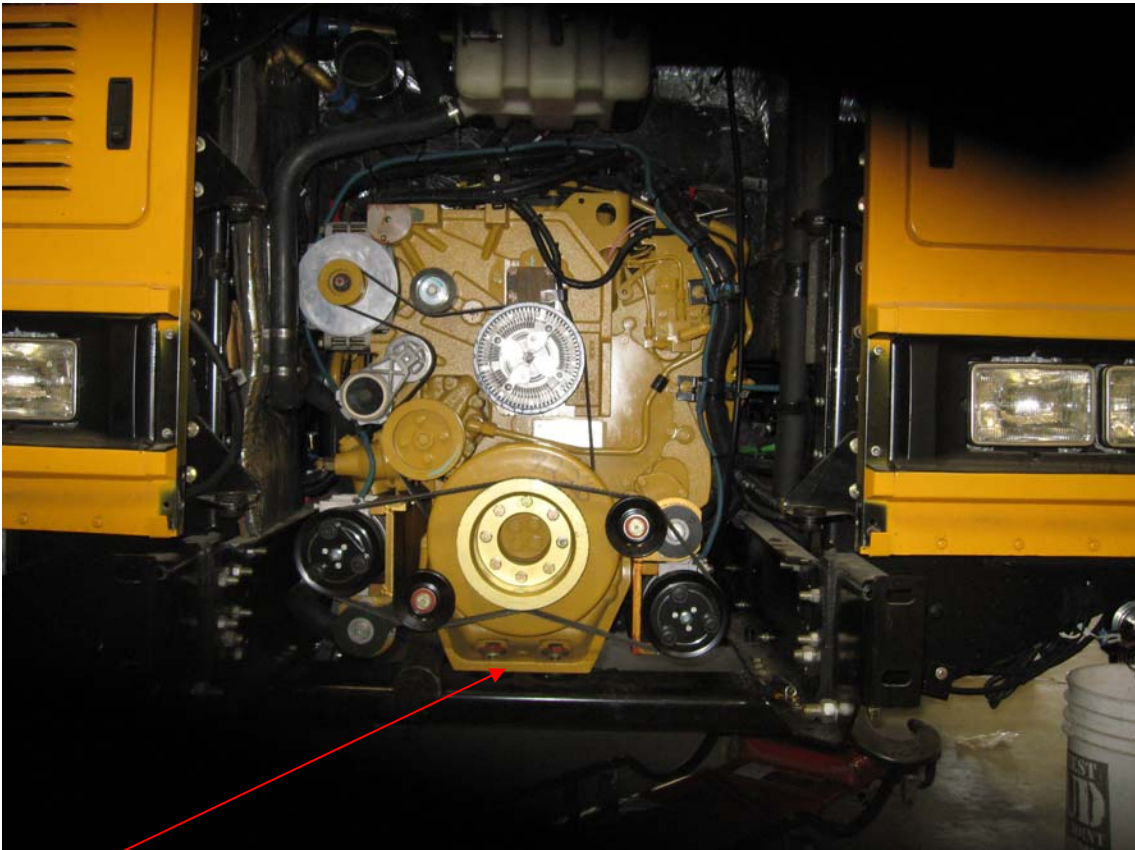

- BMK70075 (NEW CROSSMEMBER) NOT SHOWN FOR CLARITY.

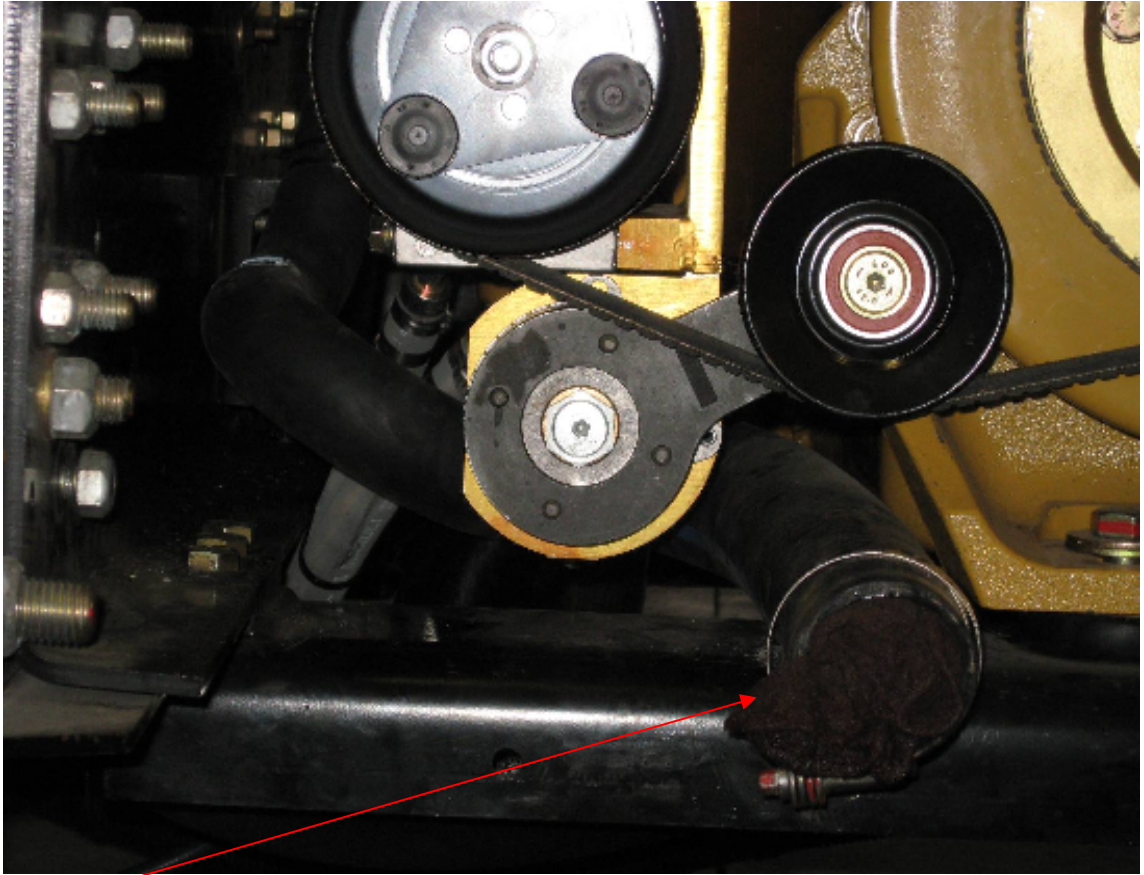

- KEEP RAD HOSE AWAY FROM TENSIONER ARM MAXIMUM DISTANCE BY SECURING TO CHASSIS CROSS MEMBER. CAN BE DONE AFTER INSTALLATION FROM BELOW USING CABLE TIES.

TransArctic A/C Compressor Mount Installation Disclaimer

All compressor mounts should be installed by qualified and trained personnel using proper tools and equipment in safe working conditions following industry standard guidelines for motor vehicle service and repair.

The installer of any compressor mount purchased from TransArctic must undertake all responsibility of issues arising from that compressor bracket being installed on any vehicle. As well as insure that a **proper and sufficient ground** is established between the compressors' clutches and the vehicle's engine. Mount functionality, operation and durability can all be compromised by an incompetent installation.

Due to the many different situations, parameters and application criteria, which are beyond the compressor mount manufacturer's control, TransArctic does not warrant design, durability, or operational functionality of any compressor mount improperly installed by another party.

With no implied guarantees it is the mount installer's strict responsibility to determine safety and functionality, of the compressor mount, at the time of installation.

Please contact TransArctic with any issue arising from installation so we may better improve the product. If you have any reservations about the compressor mount integrity contact TransArctic immediately at 1-877-COLD-AIR.